

SILKSTONE CITATIONS
Table of Contents

Blackstone Road Precinct	Blackstone Road
Corralyn	101 Glebe Road
House	78 Glebe Road
Glenville House	128 South Station Road
House	12 Morris Street
House	14 Morris Street
Silkstone State School	95 and 95a Glebe Road
House	129 South Station Road
House	143 South Station Road
House	145 South Station Road

Name Blackstone Road, Silkstone Precinct
Former/Other Name
Category Precinct
Location 156, 160, 162, 164, 168, 170, 174; 185, 187, 189, 199 Blackstone Road, Silkstone
RPD Various as per the above addresses
Local Authority Ipswich City Council
AMG Map Sheet SG 56-14, Ipswich **Grid** MQ7645
Present Tenure Various as per the above addresses
Listing Boundary All land, public or private, circumscribed on the accompanying map, plus adjoining footpath and including all established trees.
Other Listings

History

Description

This precinct lies either side of Blackstone Road as it dips away to the east, from the Cothill Road corner opening up views to Blackstone. The vacant corner lot at 156 Blackstone Road, was until recent times noted for a small, historic timber shop with exposed stud framing to chamferboarded walls, and awning posts supporting an awning, truncated and dipping as it turned the corner, stepped down from a main step hip which was also faceted to the corner. The adjacent house at 160 Blackstone Road is low set, similarly to the former shop. Its steep pyramid roof, extended to the rear, is set down to curve over enclosed verandahs.

Looking west, up from the lower extent of the precinct, the house at 170 Blackstone Road is sited high on an embankment and planted with palms to the street frontage. Front verandah bays are open, with unobtrusive metal balustrade, and fan-shaped fretwork brackets dominant above the post mouldings. The pyramid roof is stepped down in bull-nosed form over front and enclosed side verandahs.

Sited lower on the embankment, the house at 174 Blackstone Road has a similar roof shape, but in a straight profile over the verandahs. The front verandah is substantially open, with distinctive double posts either side of the entrance. Balustrading is an unusual, and elegant, combination of dowels, rails and fretwork brackets. Other houses in the precinct, more secluded from view, exhibit, generally typical interesting form and often well-conserved detail.

Significance **Level** *X*local city regional state national

- This precinct is significant in the local context as a collection of typical and interesting historic house forms effective in the townscape

Significance of Interior Not inspected

Associated Items

Comments

Note: This report has been prepared on the basis of evidence examined by the investigator(s) and seeks to identify the most important heritage values of the item. The purpose of this report is to provide an initial evaluation. A conservation study by a qualified practitioner should be completed before any action is taken which may affect the significance of the item.

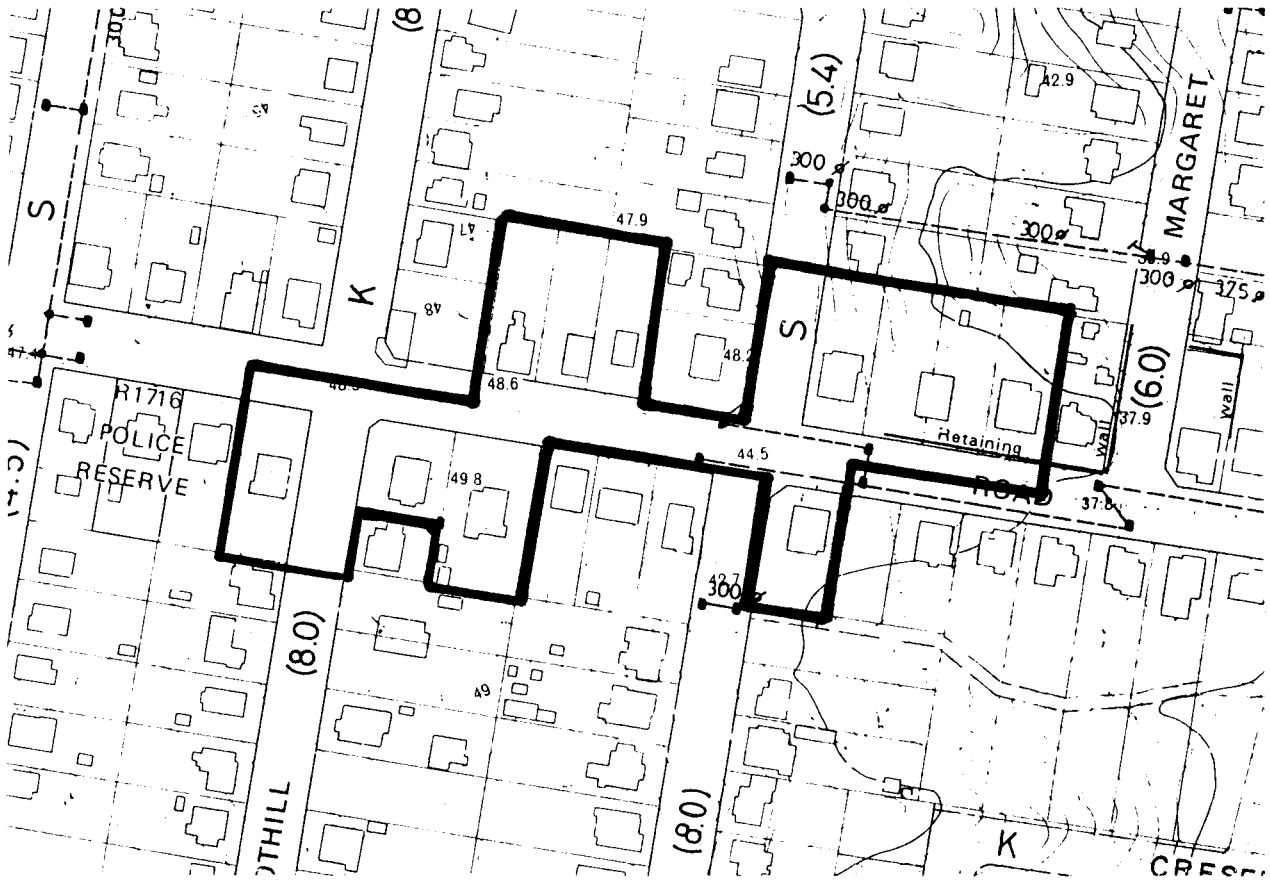

Source: Ipswich City Council. City of Ipswich topographic series. Amended to August 1990. Scale 1:2500. North at top of map. "@" = associated items.

Name "Corralynn"
Former/Other Name Legacy Flats
Category House
Location 101 Glebe Road, Silkstone
RPD L1 RP79601 Par Ipswich
Local Authority Ipswich City Council
AMG Map Sheet SG 56-14, Ipswich **Grid** MQ7645
Present Tenure Mr R & Mrs R C Boughen, 101 Glebe Road, Silkstone
 Qld 4304
Listing Boundary Whole allotment, plus adjoining footpath and
 including all established trees

Other Listings**History**

The current owner believes the home was originally built by the Walker family, associated with Ipswich's mining industry. The original property has been subdivided and 101 Glebe Road currently occupies .22ha. In 1954 it was converted into three flats for the use of returned servicemen and women.

Description

This highset house has a corrugated iron, pyramid roof, with gablets, and a separate convex roof over three verandahs. The entry is defined by a pediment, with timber finial, and lattice doors. Other decorative features include the triple-rail balustrade, unusual timber valance and arches of paling which span between its timber stumps. A central front stair has access stairs on either side.

Significance **Level** local xcity regional state national

- As an example of a Federation style Queensland home.
- Its association with the Walker family, associated with Ipswich's mining industry.

Significance of Interior

Not inspected. A newspaper article in 1991 noted that the house has five double-sized bedrooms, three open verandahs, a formal lounge, dining room and a small sitting room all separated by ornate timber archways, a massive living room, a modern kitchen and two bathrooms with car accommodation and a workroom under.

Associated Items**Comments**

Historical information and details on interior in *Queensland Times*, 23 January 1991, p17.

Note: This report has been prepared on the basis of evidence examined by the investigator(s) and seeks to identify the most important heritage values of the item. The purpose of this report is to provide an initial evaluation. A conservation study by a qualified practitioner should be completed before any action is taken which may affect the significance of the item.

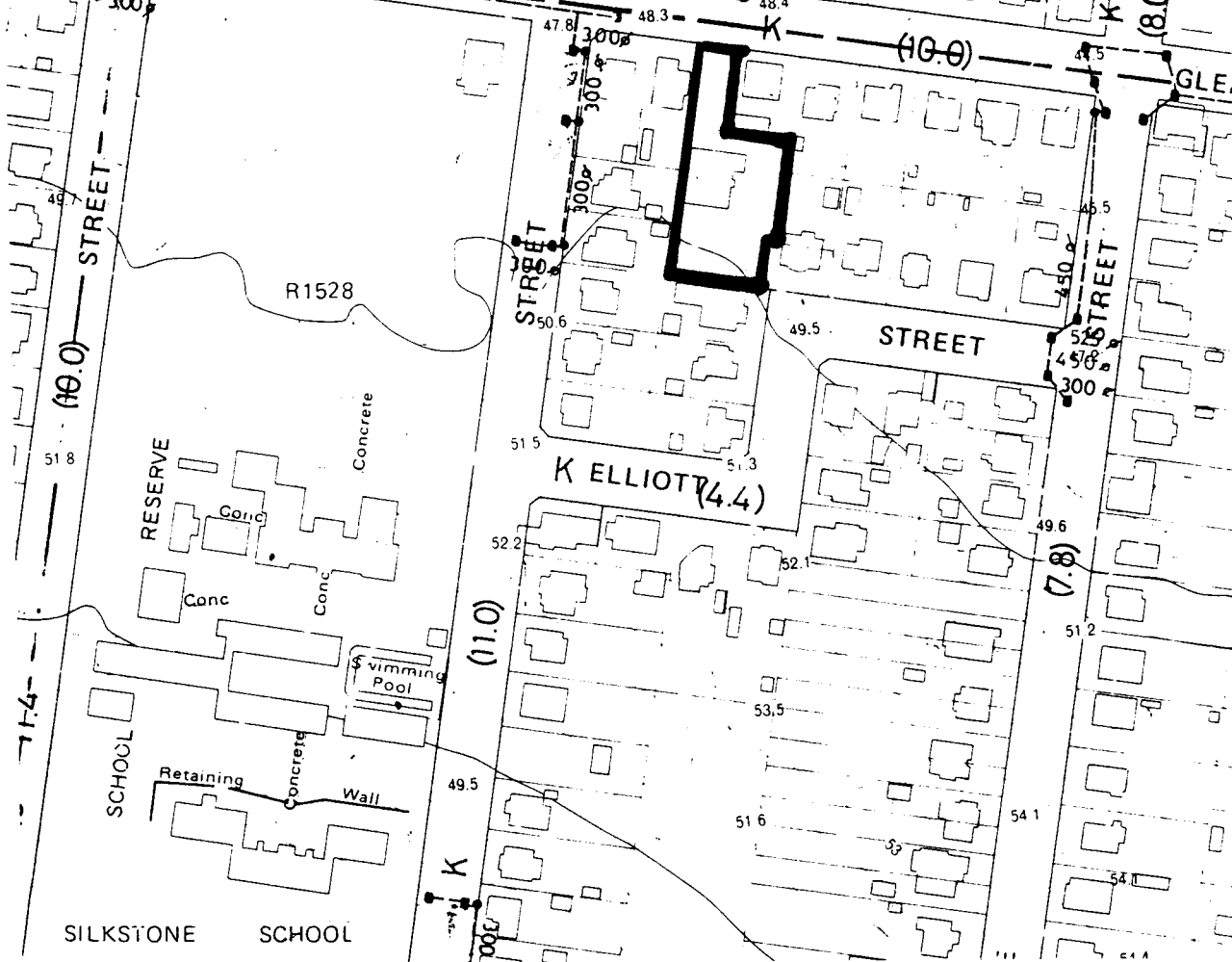

Source: Ipswich City Council. City of Ipswich topographic series. Amended to August 1990. Scale 1:2500. North at top of map. "@" = associated items.

Name 78 Glebe Road, East Ipswich

Former/Other Name

Category House

Location 78 Glebe Road, East Ipswich

RPD L2 RP54981 Par Ipswich

Local Authority Ipswich City Council

AMG Map Sheet SG 56-14, Ipswich **Grid** MQ7645

Present Tenure Mr G I Martin, 78 Glebe Road, East Ipswich Qld
4305

Listing Boundary Whole allotment, plus adjoining footpath and
including all established trees.

Other Listings

History**Description**

This house sits proudly on the corner of Glebe Road and Wilson Street, with plantings at the front, although sparse, providing contrasting vertical elements to the house's bungalow style. Its corrugated iron roof extends over the wrap around verandahs, and features a slatted apical gablet with finial. This detail is repeated in the entry, with a slatted pediment infill, also with finial. The side verandahs have been partitioned off at the point of the front verandah wall, which has exposed nogging. Full length sash windows overlook the front verandah, which features some unusual and graceful timber detailing. The triple rail doweled balustrading is contrasted by crossed members central to the verandah bays. These crossed members also feature between the paired uprights of the entry bay. The paired, curved, solid timber brackets atop the verandah uprights are complemented by the curved pieces in the small verandah entry gate. The front picket fence frames the picture.

Significance	Level	Xlocal	city	regional	state	national
•	As an example of traditional materials, form and detail					
•	For its streetscape value.					

Significance of Interior Not inspected

Associated Items**Comments**

Note: This report has been prepared on the basis of evidence examined by the investigator(s) and seeks to identify the most important heritage values of the item. The purpose of this report is to provide an initial evaluation. A conservation study by a qualified practitioner should be completed before any action is taken which may affect the significance of the item.



Source: Ipswich City Council. City of Ipswich topographic series. Amended to August 1990. Scale 1:2500. North at top of map. "@" = associated items.

Name "Glenville House"

Former/Other Name

Category House

Location 128 South Station Road, Silkstone

RPD L1 RP62232 Par Ipswich

Local Authority Ipswich City Council

AMG Map Sheet SG 56-14, Ipswich **Grid** MQ7645

Present Tenure Mr A & Mrs K Tucker, 128 South Station Road, Silkstone Qld 4304

Listing Boundary Whole allotment, plus adjoining footpath and including all established trees

Other Listings

History

The house is believed to have been built for the Treloar family, who were associated with Ipswich's mining industry. The adjacent house, "Glen Villa" was originally part of the Treloar property. The family also owned Glenville Hall, which was shifted in 1946 to a site near the Raceview State School. The current owner purchased the property in 1946. The present garage is believed to have been partially built out of the slab timber of the original coach house.

Description

The house is rectangular plan, low set on concrete stumps. It has a corrugated iron, pyramid roof, with a separate straight roof over three verandahs and a pediment over its entry. Decorative timber features include pairs of brackets beneath the eaves, and a balustrade which combines small cross braces above dowel uprights. The external walls are unlined exposing cross-bracing and horizontal beams. French doors provide access to the verandahs and the front door has sidelights, typical of Federation era homes. At the rear of the house is an early extension, featuring a brick chimney, with double sided-fireplaces to the kitchen and lounge room. The garden surrounds are formal, with some fruit growing still allowed by the size of the land, being .1742ha.

Significance **Level** *local* *xcity* *regional* *state* *national*

- As an example of a large family home, typical of the Federation era.
- Its association with the Treloar family, who were associated with Ipswich's mining industry.

Significance of Interior

The interior is mostly intact, with the exception that the present lounge has been formed by removing a wall between two former rooms.

Associated Items

Adjacent property, "Glen Villa", 130 South Station Road, Silkstone.

Comments

Historical information supplied by current owners, Mr and Mrs Tucker.

Note: This report has been prepared on the basis of evidence examined by the investigator(s) and seeks to identify the most important heritage values of the item. The purpose of this report is to provide an initial evaluation. A conservation study by a qualified practitioner should be completed before any action is taken which may affect the significance of the item.

Name 12 Morris Street, Silkstone

Former/Other Name

Category House

Location 12 Morris Street, Silkstone

RPD L2 RP24364 & L2 RP24365 Par Ipswich

Local Authority Ipswich City Council

AMG Map Sheet SG 56-14, Ipswich **Grid** MQ7645

Present Tenure Mr L E Margaritis, 150 Fegen Drive, Moorooka Qld 4105

Listing Boundary Whole allotment, plus adjoining footpath and including all established trees.

Other Listings**History****Description**

This weatherboard house, low set on concrete stumps, sits on the corner of Morris and Dwyer Streets, close to the front alignment of a longer than usual allotment. The house has been progressively enlarged with extensions to the rear. A square, corrugated iron, pyramid roofed structure to the rear, presumably originally a detached kitchen house, has been joined to the main house by the enclosure of a skillion roofed rear section. This kitchen house has at its rear an enclosed, bull-nosed verandah. The main house has a corrugated iron, pyramidal roof with short eaves, with a stepped down, convex, corrugated iron roof over the front verandah. Sash windows overlook this front verandah, whose walls have been sheeted with horizontal chamferboards. The verandah has been sheeted to handrail height with chamferboards, with a decorative feature central to each verandah bay of horizontal slats below the handrail.

Significance **Level** *X*local city regional state national

- As an example of traditional materials, form and detail

Significance of Interior Not inspected

Associated Items

The house adjacent at 14 Morris Street, Silkstone.

Comments

Note: This report has been prepared on the basis of evidence examined by the investigator(s) and seeks to identify the most important heritage values of the item. The purpose of this report is to provide an initial evaluation. A conservation study by a qualified practitioner should be completed before any action is taken which may affect the significance of the item.

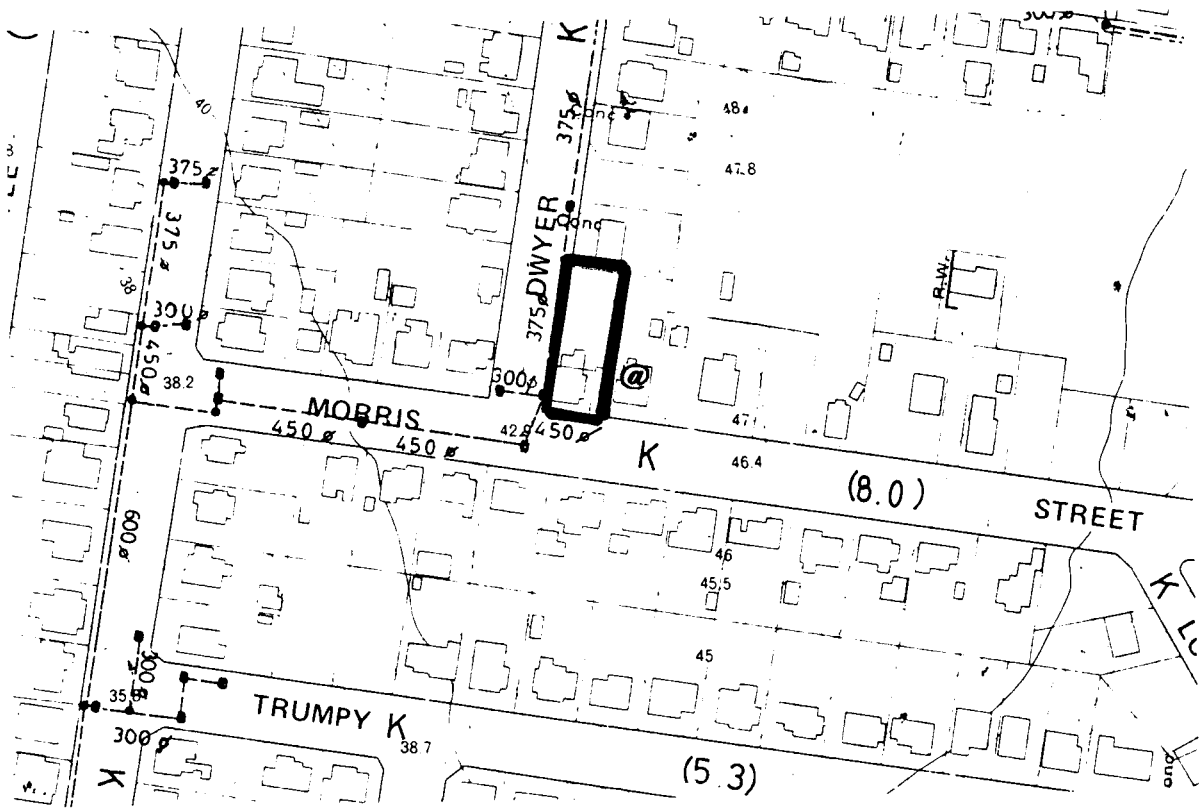

Source: Ipswich City Council. City of Ipswich topographic series. Amended to August 1990. Scale 1:2500. North at top of map. "@" = associated items.

Name 14 Morris Street, Silkstone

Former/Other Name

Category House

Location 14 Morris Street, Silkstone

RPD L5 Rp107212 par Ipswich

Local Authority Ipswich City Council

AMG Map Sheet SG 56-14, Ipswich **Grid** MQ7645

Present Tenure Mr J A & Mrs L K Pettersson, 14 Morris Street,
Silkstone Qld 4304

Listing Boundary Whole allotment, plus adjoining footpath and
including all established trees.

Other Listings**History****Description**

This house, low set on concrete stumps, appears to have been formed by the conjoining of two pyramid roofed sections, The roof closest to Morris Street is not as steep as that to the rear, and features a small ridge. Both are of corrugated iron, as is the stepped down verandah which extends the entire length on the right side, but only part was down the left side. This part of the verandah to the left has been sheeted in with weatherboards, whilst the only other enclosing of the verandah is the use of lattice panels above the handrail on the right. The front verandah wall is lined internally with horizontal boards with an exposed frame featuring cross bracing. Other walls are lined externally. Timber detailing on the verandah includes triple rail dowelled balustrading and unadorned chamfered uprights. French doors lead onto the verandah, and the windows of the rear section feature timber and corrugated iron window hoods. The house is set back from the front alignment on a larger than usual block, and features a traditional mango planting adjacent to its northeasterly corner.

Significance *Level* *Xlocal* *city* *regional* *state* *national*

- As an example of traditional materials and detail, with an unusual combination of traditional forms

Significance of Interior Not inspected

Associated Items

The house adjacent at 12 Morris Street, Silkstone, listed separately.

Comments

Note: This report has been prepared on the basis of evidence examined by the investigator(s) and seeks to identify the most important heritage values of the item. The purpose of this report is to provide an initial evaluation. A conservation study by a qualified practitioner should be completed before any action is taken which may affect the significance of the item.

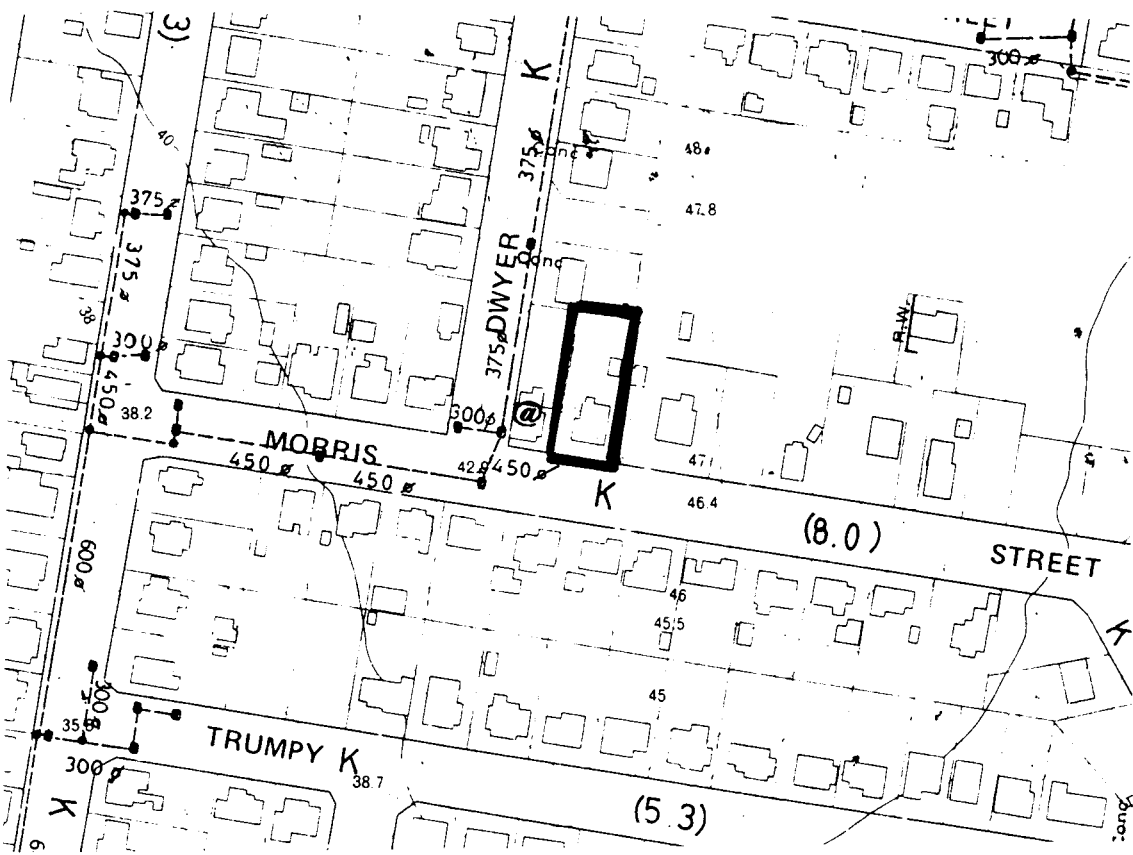

Source: Ipswich City Council. City of Ipswich topographic series. Amended to August 1990. Scale 1:2500. North at top of map. "@" = associated items.

Name Silkstone State School
Former/Other Name
Category School building and residence
Location 95 and 95A Glebe Road, Silkstone
RPD Reserve 1528 ~ S6/25 P123 & S15 P124 Par Ipswich
Local Authority Ipswich City Council
AMG Map Sheet SG 56-14, Ipswich **Grid** MQ7645
Present Tenure Regional Director of Education, c/- Department of Administrative Services, GPO Box 2457, Brisbane Qld 4001
Listing Boundary Whole allotment, plus adjoining footpath and including all established trees.
Other Listings

History

With the expansion of Silkstone / Booval at the turn of the century, there was a need for a larger school than Newtown State School, opened in 1882 on the site of the present Newtown Park, then considered on the outlying part of town. An eight acre allotment owned by Molloy was selected, particularly in view of the fact that it was opposite Cameron Park. A foundation tablet was laid by the Hon J Blair, Minister for Education on 15th May, 1915. The official opening of the School took place on Saturday, 4 December, 1915 and classes, including for those pupils from the closed Newtown State School, began at the beginning of the 1916 school year.

The school building had an 'E' shaped configuration, built by John Hutchinson according to the then Department of Public Instruction's latest plans. There were in all 10 classrooms, eight of a size of 24' by 24', two larger ones at 29' by 24', and a teacher's room and an office for the head teacher. The contract had also included the residence. French tiles were used for roofing as there was a war time shortage of corrugated iron; however storm damage has meant that they were eventually replaced with corrugated iron. Water was supplied by tanks. The first tree planting, according to the advice of the Queen's Park Curator, F W Turley, took place on 1 May, 1916 with the help of some explosives to loosen the deeper soil. Fencing was urgently sought in the 1920's as there was trouble with cattle straying on to the site, and jockeys and horse trainers used the footpath, thus potentially endangering children. An infant's school opened in 1923, and the pool was opened after much local fund raising in 1926.

Much of the ground improvements were made by unemployment relief labour of the 1930's Depression. This work included terracing the grounds on the Glebe Road entrance using stone from the Thomas Estate at Blackstone; top dressing the tennis courts; and building fences, seating, retaining walls and bitumen paths. Around 1940 the grounds were extended by purchasing the housing allotments on the Prospect Street boundary. Slit trenches were built during World War II in case of air raids, and a part of the school was bricked in and sandbagged to serve as an emergency First Aid Post. The school has continued to develop, but building activity has been concentrated in the centre section of the allotment, allowing generous open grounds to the northern and southern boundaries.

Description

The one storey weatherboard 1915 school building is situated centrally on the present allotment bordered by Glebe Road, Molloy Street, Prospect Street and Blackstone Road. It stands highset on brick piers, infilled with corrugated iron sheeting. Its 'E' shaped configuration is made up of a long hipped section facing in a southerly direction, with gable ended sections extending in a northerly direction from the easterly and westerly corners, as well as a gable projection extending northerly between these.

The main front entrance is a gabled projecting porch, reached by stairs from either side. This porch gable features a slatted gable verge, similar in style to those on the main gable ends. Unusual and decorative bell-shaped ventilators are mounted over this entry porch, as well as centrally placed on the ridges of the main gable ends. The roof is corrugated iron, but some of the original tiles still exist on the substantial window hoods above large banks of windows on the main gable ends and sides. Open verandahs, featuring dowelled balustrading and slightly arched solid timber valances tapering to handrail height, are found on the walls of the northerly sections. The verandahs on the northerly end of the main gable sections have been partially enclosed with weatherboard. The central gable projection does not match the other detailing, having no gable verge decoration, and later style hopper windows without hoods.

The residence, facing Glebe Road on the corner of Molloy Street, is a one storey, weatherboard house, high set on concrete stumps. It has a corrugated iron roof decorated with apical battened gablets, extending over front and side verandahs. The square plan of the house has been extended to the rear by a hipped weatherboard projection. The verandah walls feature an exposed frame, and timber detailing includes slightly curved solid timber valances between the otherwise unadorned uprights, and simple dowelled balustrading. The house is partially screened from the road by a pair of pines planted at the northeasterly and northwesterly corners, which complement the other plantings on site. These other plantings are extensive and varied, including figs, jacarandas, leopard trees, hoop pines, sausage trees and pencil pines, with the boundary plantings around northeasterly boundaries similar to those in Cameron Park.

Significance	Level	<i>X</i> local	city	regional	state	national
---------------------	--------------	----------------	------	----------	-------	----------

- As an example of a relatively large state school built early this century
- For its extensive and varied plantings

Significance of Interior	Not inspected
---------------------------------	---------------

Associated Items

The Cameron Park, Booval Precinct opposite, listed separately.

Comments

The brick structures on the site do not require heritage constraints at this time. Historical information from *Newtown - Silkstone State School. Centenary 1882-1982*.

Note: This report has been prepared on the basis of evidence examined by the investigator(s) and seeks to identify the most important heritage values of the item. The purpose of this report is to provide an initial evaluation. A conservation study by a qualified practitioner should be completed before any action is taken which may affect the significance of the item.

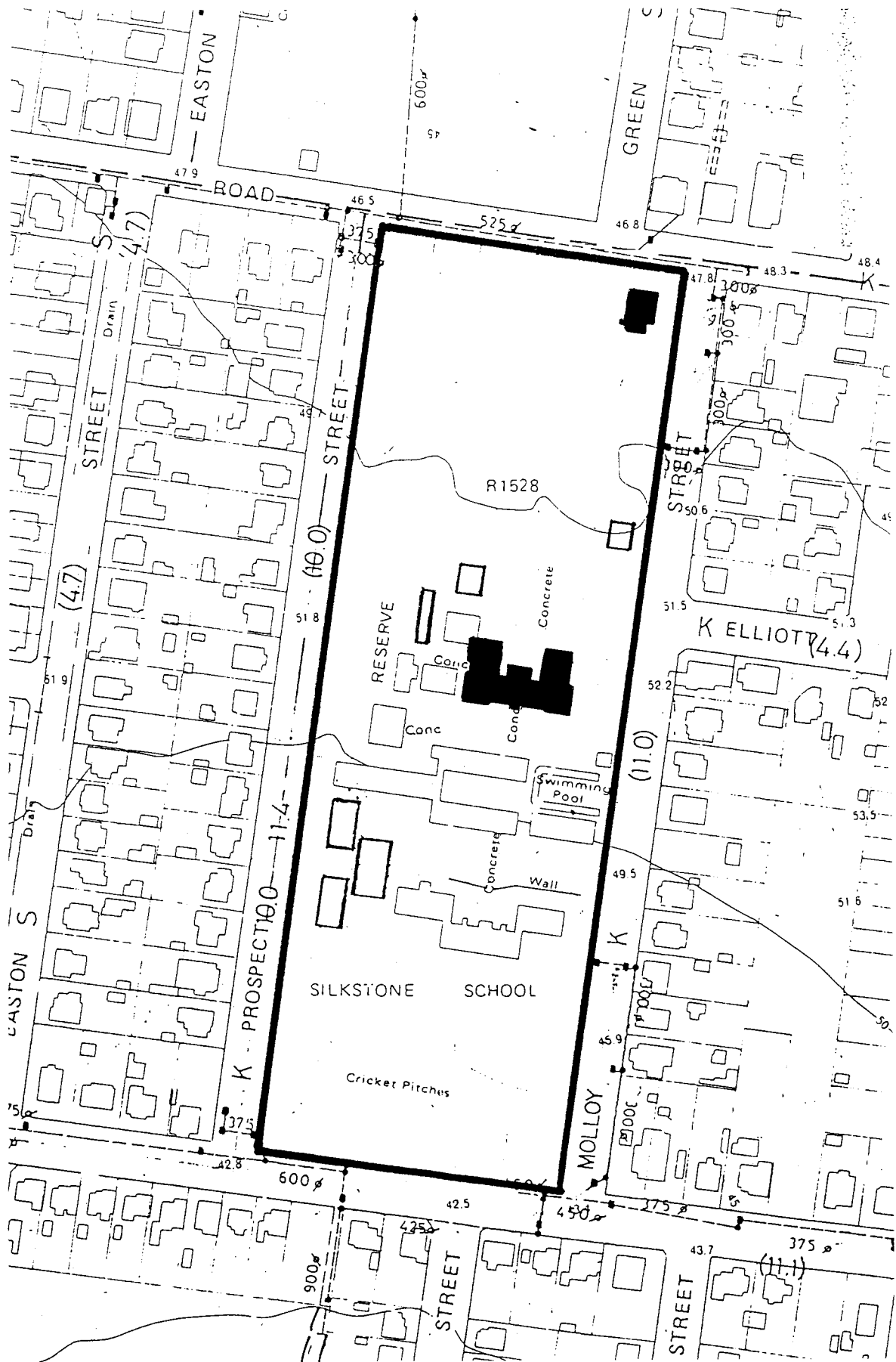

Source: Ipswich City Council. City of Ipswich topographic series. Amended to August 1990. Scale 1:2500. North at top of map. "@" = associated items.

Name 129 South Station Road, Silkstone

Former/Other Name

Category House

Location 129 South Station Road, Silkstone

RPD L48 Rp24264 Par Ipswich

Local Authority Ipswich City Council

AMG Map Sheet SG 56-14, Ipswich **Grid** MQ7645

Present Tenure Mr J J & Mrs E J Miles, 129 South Station Road, Silkstone Qld 4304

Listing Boundary Whole allotment, plus adjoining footpath and including all established trees.

Other Listings**History****Description**

This is a one storey timber house, low set on timber stumps. It is set close to the front, and northerly alignments, giving the house a spacious lawn area to the corner of Auld Street. The main pyramidal roof, with close eaves, is corrugated iron, as is the stepped down, slightly convex front verandah roof. The external walls are lined with weatherboard which continues to a sloping profile rear extension. The front verandah wall is lined internally with vertical boards, and has an exposed frame featuring nogging and cross bracing. Timber detailing on the verandah includes slatted balustrading and paired fretwork brackets atop chamfered uprights. The southern end of the verandah has been enclosed with weatherboard to sill height, and then multi-paned casements and tin window hood above. The external wall sash windows have slatted corrugated iron window hoods. A scalloped, batten fence at the front boundary completes the picture.

Significance **Level** *X*local city regional state national

- As an example of traditional materials, form and detail
- For its streetscape value.

Significance of Interior Not inspected

Associated Items**Comments**

Note: This report has been prepared on the basis of evidence examined by the investigator(s) and seeks to identify the most important heritage values of the item. The purpose of this report is to provide an initial evaluation. A conservation study by a qualified practitioner should be completed before any action is taken which may affect the significance of the item.

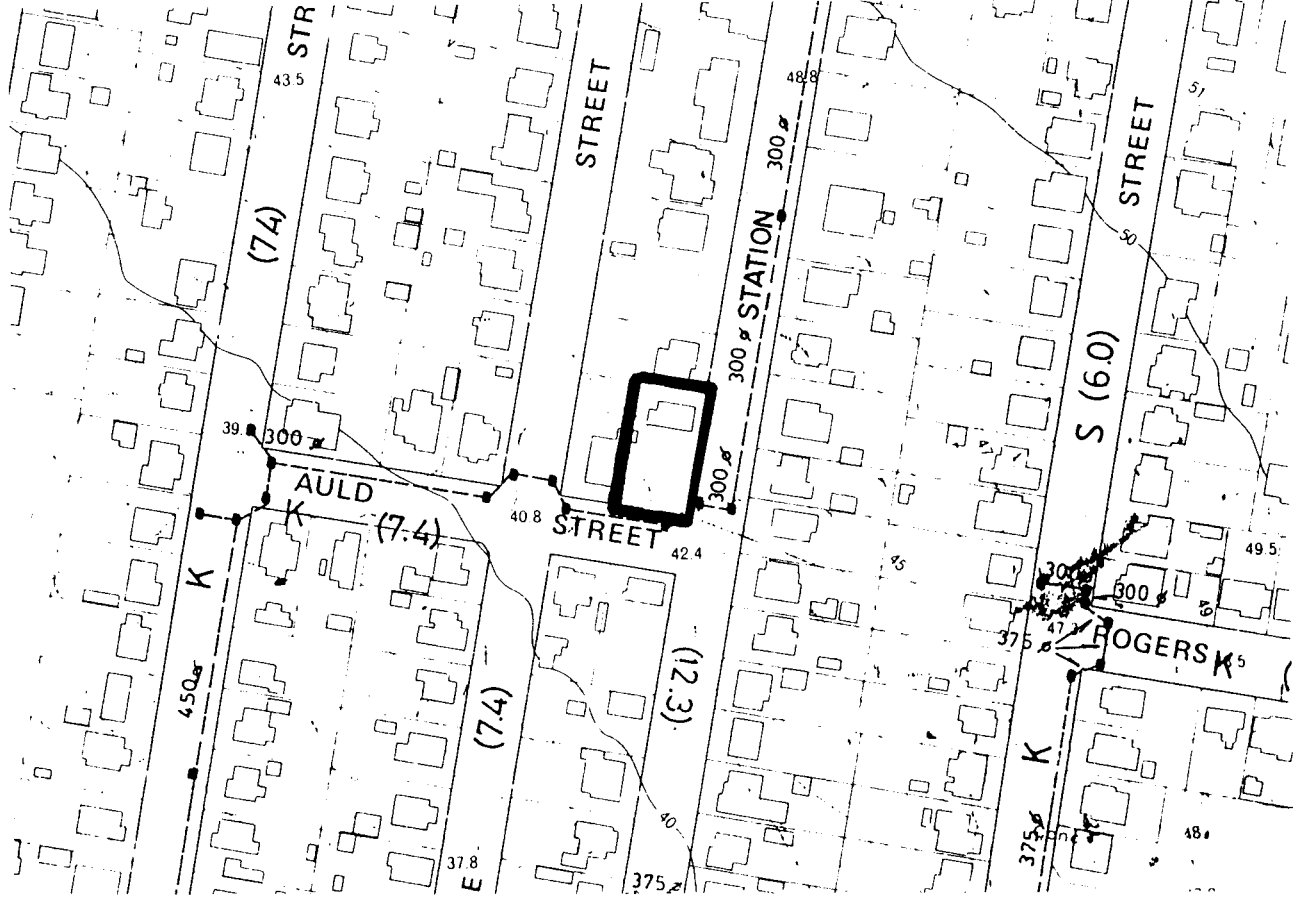

Source: Ipswich City Council. City of Ipswich topographic series. Amended to August 1990. Scale 1:2500. North at top of map. "K" = associated items.

Name 143 South Station Road, Silkstone
Former/Other Name
Category House
Location 143 South Station Road, Silkstone
RPD L1 RP118180 Par Ipswich
Local Authority Ipswich City Council
AMG Map Sheet SG 56-14, Ipswich **Grid** MQ7645
Present Tenure Mr P R & Mrs G V Chaplin, 1 Numdoo Street, Jindalee Qld 4074
Listing Boundary Whole allotment, plus adjoining footpath and including all established trees.

Other Listings**History****Description**

This is a low set house with a rear, semi-detached kitchen house. This kitchen house has a corrugated iron hipped roof, is lined with narrow chamferboards, and has casement windows. The main house, set close to the front alignment, has a pyramidal, corrugated iron roof, with a stepped down, slightly convex verandah roof, also corrugated iron, wrapping around the front and left side. The verandah walls are lined internally with horizontal chamferboards, and have an exposed frame featuring cross bracing and closely spaced studs. The verandah uprights are unadorned, and presently lacks balustrading. Lattice panels at about handrail height have been fitted to the southeasterly corner. French doors lead to the front verandah, and sash windows overlook the side verandah. A picket fence at the front alignment completes the picture.

Significance **Level** *X*local city regional state national

- As an example of traditional materials, form and detail
- For its streetscape value.

Significance of Interior Not inspected

Associated Items

The cottage at 145 South Station Road, listed separately.

Comments

Note: This report has been prepared on the basis of evidence examined by the investigator(s) and seeks to identify the most important heritage values of the item. The purpose of this report is to provide an initial evaluation. A conservation study by a qualified practitioner should be completed before any action is taken which may affect the significance of the item.

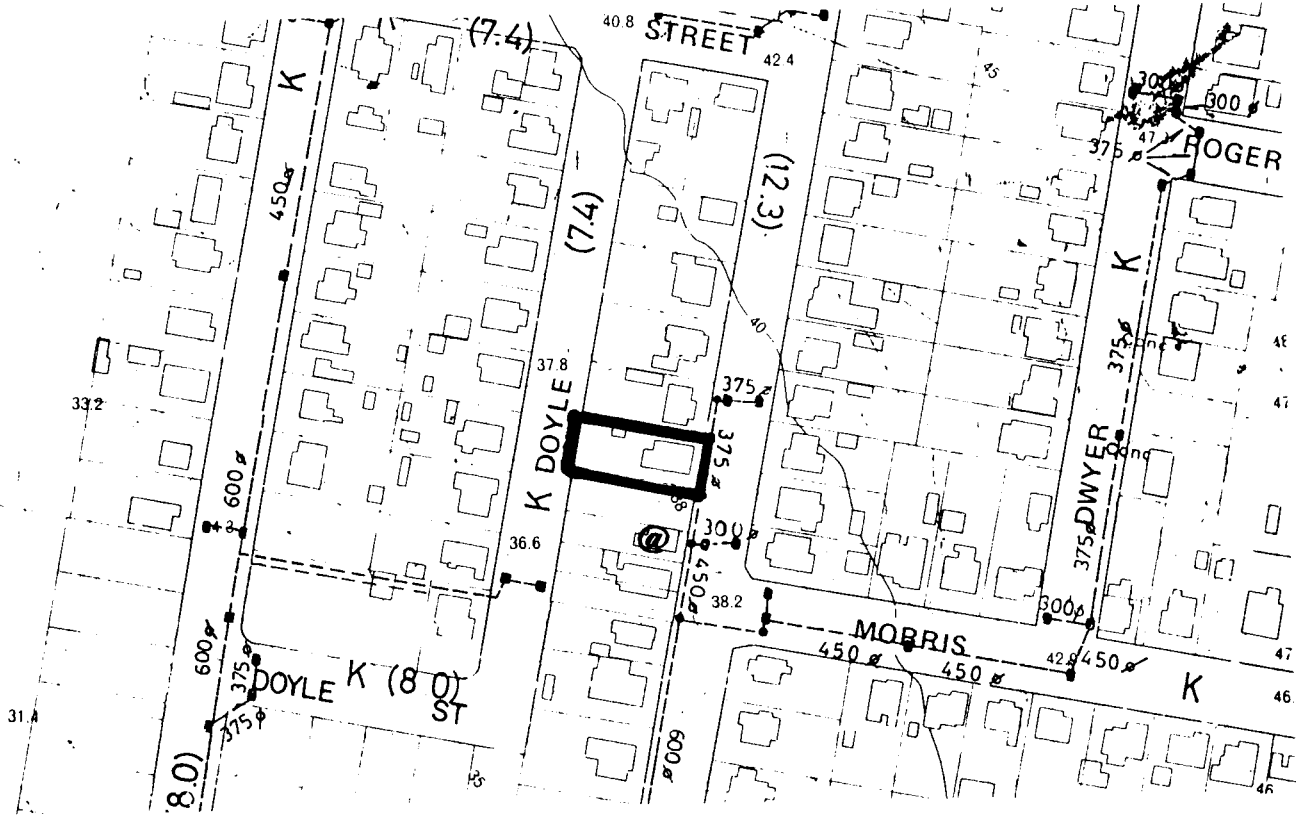

Source: Ipswich City Council. City of Ipswich topographic series. Amended to August 1990. Scale 1:2500. North at top of map. "@" = associated items.

Name 145 South Station Road, Silkstone
Former/Other Name
Category House
Location 145 South Station Road, Silkstone
RPD L4 RP24265 Par Ipswich
Local Authority Ipswich City Council
AMG Map Sheet SG 56-14, Ipswich **Grid** MQ7645
Present Tenure Mr P E & Mrs D F Carroll, 145 South Station Road,
Silkstone Qld 4304
Listing Boundary Whole allotment, plus adjoining footpath and
including all established trees.

Other Listings**History****Description**

This is a modest gable ended dwelling, low set close to the front alignment. Its steeply pitched corrugated iron roof is repeated at the rear. Its slightly convex verandah roof, curving over the front verandah, is also of corrugated iron. The house is sheeted externally with chamferboard, and lattice panels are fitted above handrail height at the ends of the verandah. Otherwise, the verandah is open and has unadorned chamfered uprights and a simple balustrading of timber pieces fixed to form triangles. A picket fence along the front alignment completes the picture.

Significance	Level	Xlocal	city	regional	state	national
•	As an example of traditional materials, form and detail.					
•	For its streetscape value					

Significance of Interior Not inspected

Associated Items

The house at 143 South Station Road, listed separately.

Comments

Note: This report has been prepared on the basis of evidence examined by the investigator(s) and seeks to identify the most important heritage values of the item. The purpose of this report is to provide an initial evaluation. A conservation study by a qualified practitioner should be completed before any action is taken which may affect the significance of the item.

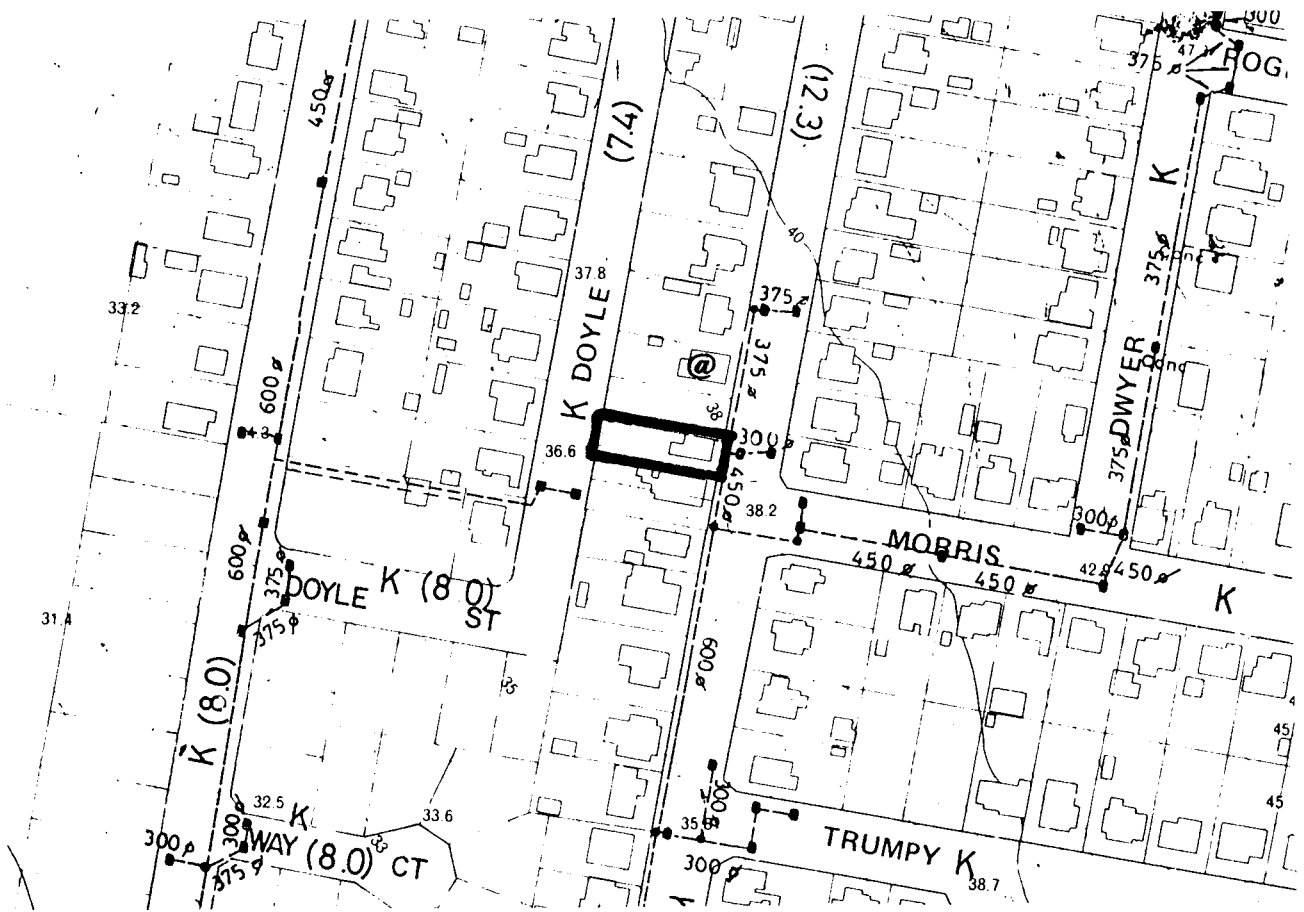

Source: Ipswich City Council. City of Ipswich topographic series. Amended to August 1990. Scale 1:2500. North at top of map. "@" = associated items.