

RIVERVIEW CITATIONS
Table of Contents

Anchorage Farm Manager's Residence	29 Riverview Road
Avenue of Bunya Pines	29 Riverview Road
Canaan	29 Riverview Road
General Booth's Hoop Pines	29 Riverview Road
Salvation Army Anchorage Farm Precinct	29 Riverview Road
House	89 Brisbane Road
House	6 Hansell's Parade
House	12 Hansell's Parade
Trees	16 Station Road

Name Anchorage Farm Manager's Residence
Former/Other Name
Category House
Location 29 Riverview Road, Riverview
RPD L35 M33137 & L1 RP193150 & L2 RP22229 & L6/7
 RP22230 Parish of Goodna
Local Authority Ipswich City Council
AMG Map Sheet SG 56-14, Ipswich **Grid** MQ7645
Present Tenure The Salvation Army Endeavour Anchorage, PO Box 119,
 Booval Qld 4304
Listing Boundary To the extent of the current fencing enclosure,
 approximated on the accompanying map.
Other Listings

History

The dwelling is believed to have been the first built on the site. From 1893 at least, the site was used as a boys' home. (See entry for Salvation Army Anchorage Farm for general history.) This house was probably built during the late 1880s or early 1890s. Although the house has been extended at some time, many of its features and fittings remain intact.

Description

The house has a long-ridge hipped roof of corrugated iron, with two hipped rear projections. It has a separate straight roof over its front and side verandahs, the latter of which is now enclosed. Spanned between the chamfered verandah support posts is an intricate, cast-iron valance. There are no balustrades. The front door has red and blue glass sidelights, and the two front windows, either side of the entry, are 6 pane double hung sashes. The house has three chimneys, one of which is double-sided. The external front wall and a side wall are lined with an 8" chamferboard whilst internally beaded vertical joint boards are typical. A central front path leads from the paling fence to the front steps. The fence, the path and the front verandah are lined by a garden bed in a formal manner. The Norfolk pine planted by General Booth is close by and the front of the house is framed by plantings which include two palms and a Blackbean tree.

Significance	Level	<i>local</i>	<i>city</i>	<i>regional</i>	<i>xstate</i>	<i>national</i>
•	As a rare example of a substantially intact, late Colonial/early Federation house and garden.					
•	As evidence of the Salvation Army's continued social/community service on the Anchorage Farm site.					

Significance of Interior

Many features are intact, such as fanlight fretwork, fireplace surrounds and sidelight glass.

Associated Items

This building is within the Salvation Army Anchorage Farm Precinct, listed separately. The nearby "Canaan" and the Norfolk pine planted by General Booth are both listed separately also.

Comments

Note: This report has been prepared on the basis of evidence examined by the investigator(s) and seeks to identify the most important heritage values of the item. The purpose of this report is to provide an initial evaluation. A conservation study by a qualified practitioner should be completed before any action is taken which may affect the significance of the item.

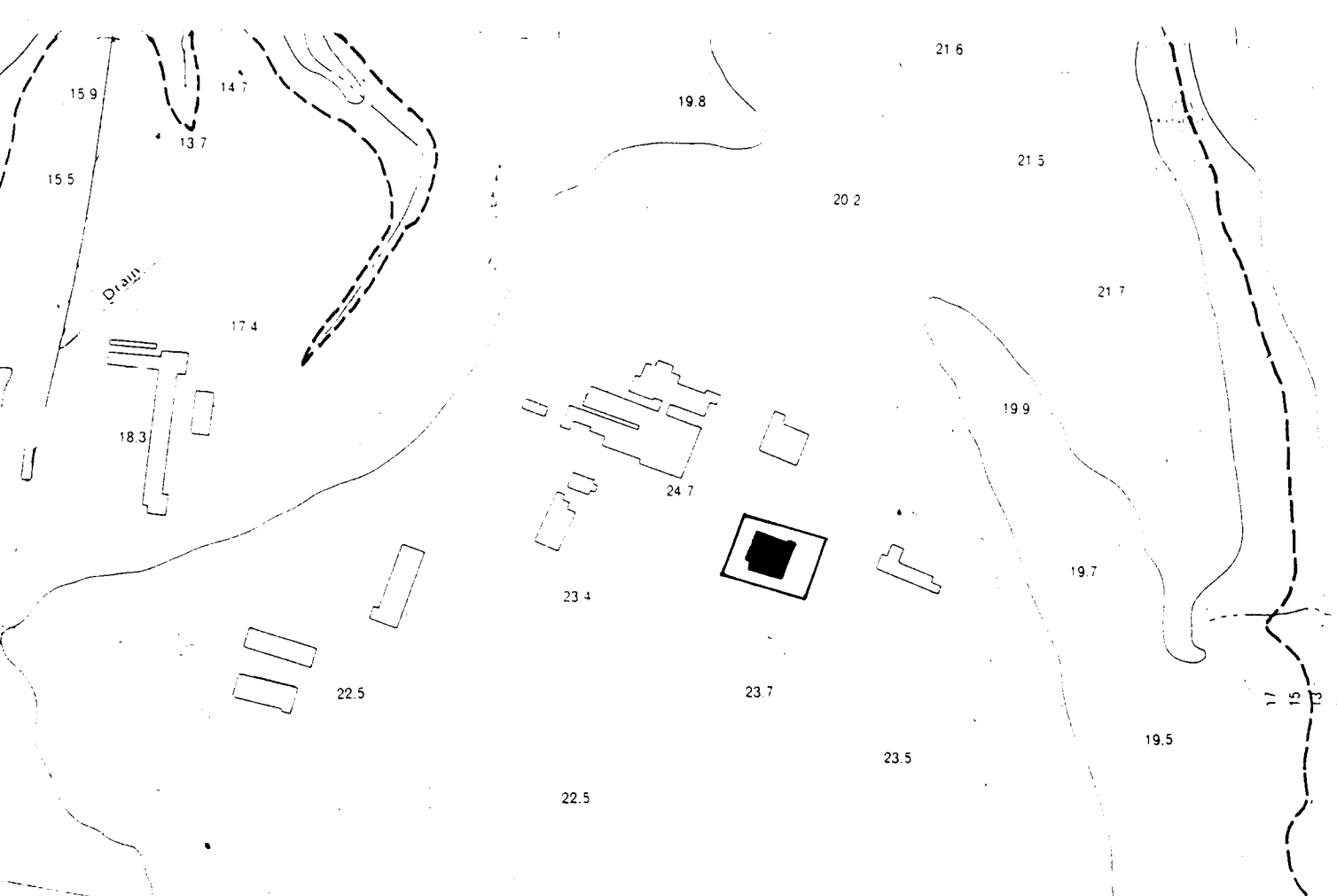

Source: Ipswich City Council. City of Ipswich topographic series. Amended to August 1990. Scale 1:2500. North at top of map. "@" = associated items.

Name Avenue of Bunya Pines

Former/Other Name

Category Trees

Location 29 River Road, Riverview

RPD L35 M33137 & L1 RP193150 & L2 RP22229 & L6/7 RP22230

Local Authority Ipswich City Council

AMG Map Sheet SG 56-14, Ipswich **Grid** MQ7645

Present Tenure The Salvation Army Endeavour Anchorage, PO Box 119, Booval Qld 4304

Listing Boundary The greater of the circumference of the canopy or root system of individual pines, and all land between the pines including the road.

Other Listings**History**

The trees are believed to have been planted around 1920 by Salvation Army personnel, Captain and Mrs Glitheroe and boys from the farm. The avenue of trees replaced a bush track.

Description

An avenue of tall, mature Bunya Pines creates an impressive entry to this historically important site. The trees contribute to the site's historic and scenic value and are integral to it.

Significance **Level** *local* *city* *regional* *Xstate* *national*

- As evidence of the historic value of the surrounding site.
- As a landmark of landscape/townscape value.

Significance of Interior Not applicable

Associated Items**Comments**

Sources for this report include submissions to the 1984 Grand Tree Competition, records of which are held by the Ipswich City Council.

Note: This report has been prepared on the basis of evidence examined by the investigator(s) and seeks to identify the most important heritage values of the item. The purpose of this report is to provide an initial evaluation. A conservation study by a qualified practitioner should be completed before any action is taken which may affect the significance of the item.



Source: Ipswich City Council. City of Ipswich topographic series. Amended to August 1990. Scale 1:7500. North at left of map. "*" = associated items.

Name "Canaan"

Former/Other Name

Category Hostel

Location 29 Riverview Road, Riverview

RPD L35 M33137 & L1 RP193150 & L2 RP22229 &
L6/7 RP22230 Parish of Goodna

Local Authority Ipswich City Council

AMG Map Sheet SG 56-14, Ipswich **Grid** MQ7645

Present Tenure The Salvation Army Endeavour Anchorage, PO Box 119,
Booval Qld 4304

Listing Boundary To the extent of the 1897 fenced enclosure,
approximated on the accompanying map.

Other Listings**History**

The site's use as a boys' home began as early as 1893. This structure was probably built around this time. A photograph, published in *The War Cry*, 3 September, 1988, shows the building as it was in 1897. The southern wing contains 4 rooms. The closest to the main section of the hostel was a supervisor's room. Next was the boys' dressing room, adjoining the clothing store. Behind this is the room which was the cold room. A supervisor's room was also the first room off the main hostel in the northern wing. Next came two staff bedrooms, a linen store, then the kitchen and dining room at the end. There are fireplaces in each of these last two rooms. An ablution block to the rear of the wings was built in the 1930's. Accommodation at the site was expanded with the opening in 1950 of a weatherboard and fibro barracks building which was adjoined to the northern side of the main part of the hostel. The stables and laundry to the rear of the hostel have gone. The remains of a vertical, in-ground "boiler" located to the rear of the wings were revealed during recent plumbing works.

Description

This substantial structure has a long-ridge, hipped roof, with rear hipped projections. Behind this are two hip roofed, rectangular plan wings, now principally used for accommodation. These wings are connected by a u-shaped verandah which surrounds a central, internal court yard, planted with two palm trees. Another hip roofed structure, a dining room, extends behind one wing, and a rectangular plan structure was built at the rear of the other wing during the 1930s. The entry is defined by a projecting portico and pediment with fretwork. Decorative features to the house include the timber work to the pediment, including intricate fretwork, a cast-iron valance, paired brackets to the eaves, acid etched and engraved glass in door panels and sidelights in certain surrounds, and fireplace surrounds incorporating delicately painted, ceramic tiles. Beaded vertical joint boards feature inside the house. An unusually wide central hall and four large rooms occupy the core of the house, which is connected to the accommodation wings by the verandah. Much of the house was originally surrounded by verandahs; now half the front verandah and parts of two side verandahs have been enclosed. Many of the removed fittings have been kept by the owners.

Significance **Level** *local* *city* *regional* *xstate* *national*

- For its rarity as a substantial institutional building, of the Federation era, with a high degree of decorative features and fittings.
- As evidence of the Salvation Army's continued social/community service on the Anchorage Farm site.

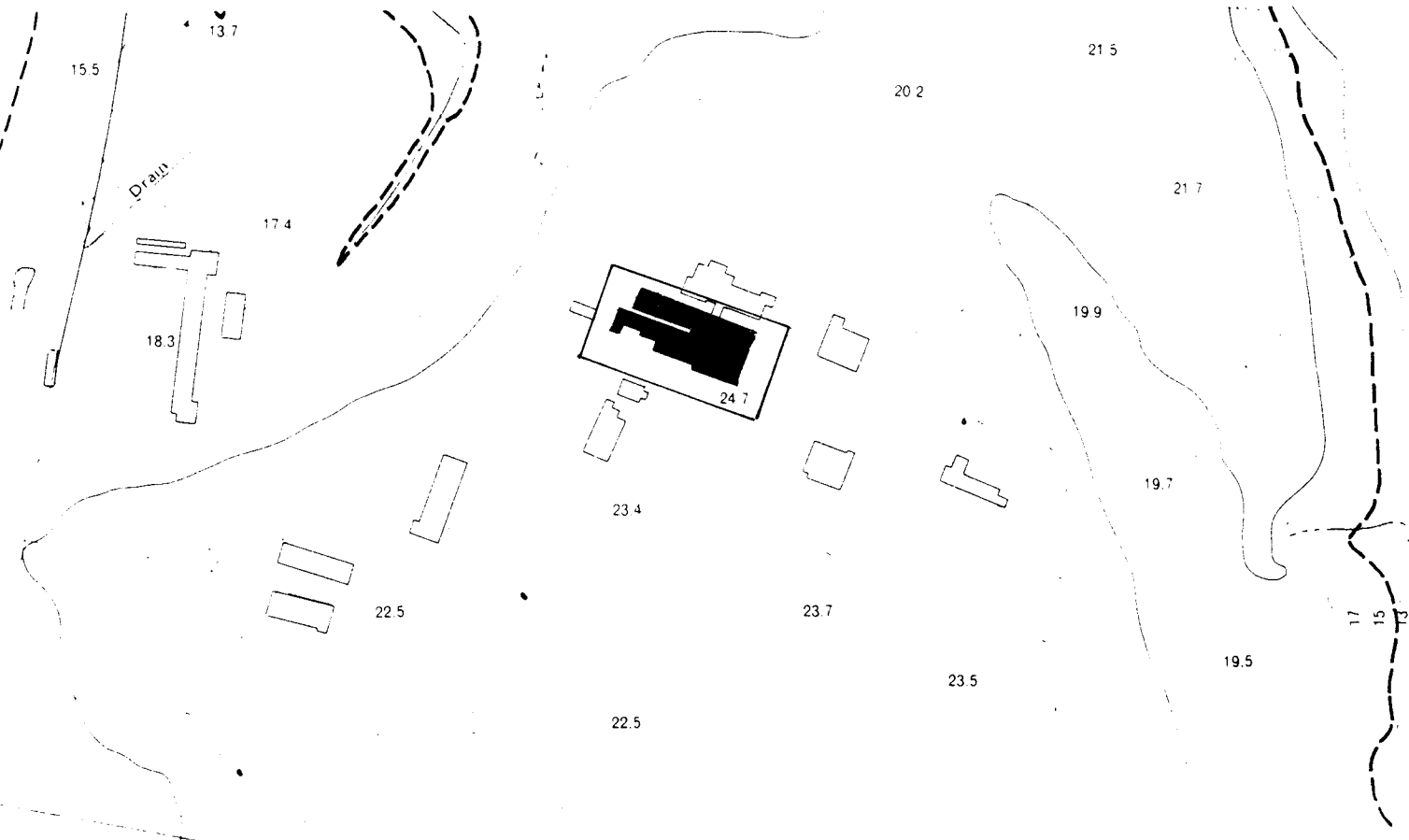

Source: Ipswich City Council. City of Ipswich topographic series. Amended to August 1990. Scale 1:2500. North at top of map. "@" = associated items.

Name General Booth's Hoop Pine

Former/Other Name

Category Tree

Location 29 River Road, Riverview

RPD L35 M33137 & L1 RP193150 & L2 RP22229 &
L6/7 RP22230

Local Authority Ipswich City Council

AMG Map Sheet SG 56-14, Ipswich **Grid** MQ7645

Present Tenure The Salvation Army Endeavour Anchorage, PO Box 119,
Booval Qld 4304

Listing Boundary The greater of the circumference of the canopy or
root system

Other Listings

History

The pine was planted by Salvation Army founder, General William Booth, in 1899. The tree has been affected by white ants.

Description

The pine stands between the farm's first structure, the manager's residence, and the "Canaan". (See individual inventory entries.) As a strong vertical element in the landscape, the pine carries with it the symbolism of Salvation Army's religious philosophy, just as spires do as an element of ecclesiastical architecture.

Significance	Level	<i>local</i>	<i>city</i>	<i>regional</i>	<i>xstate</i>	<i>national</i>
•						
•						
•						

For its historic associations with the founder of the Salvation Army.

As a landmark of landscape/townscape value, which is a repeated skyline feature in other areas of Ipswich.

As evidence of the Salvation Army's continued social/community service on this site.

Associated Items

Comments

Sources for this report include the present manager and submissions to the 1984 Grand Tree Competition, records of which are held by Ipswich City Council.

Note: This report has been prepared on the basis of evidence examined by the investigator(s) and seeks to identify the most important heritage values of the item. The purpose of this report is to provide an initial evaluation. A conservation study by a qualified practitioner should be completed before any action is taken which may affect the significance of the item.

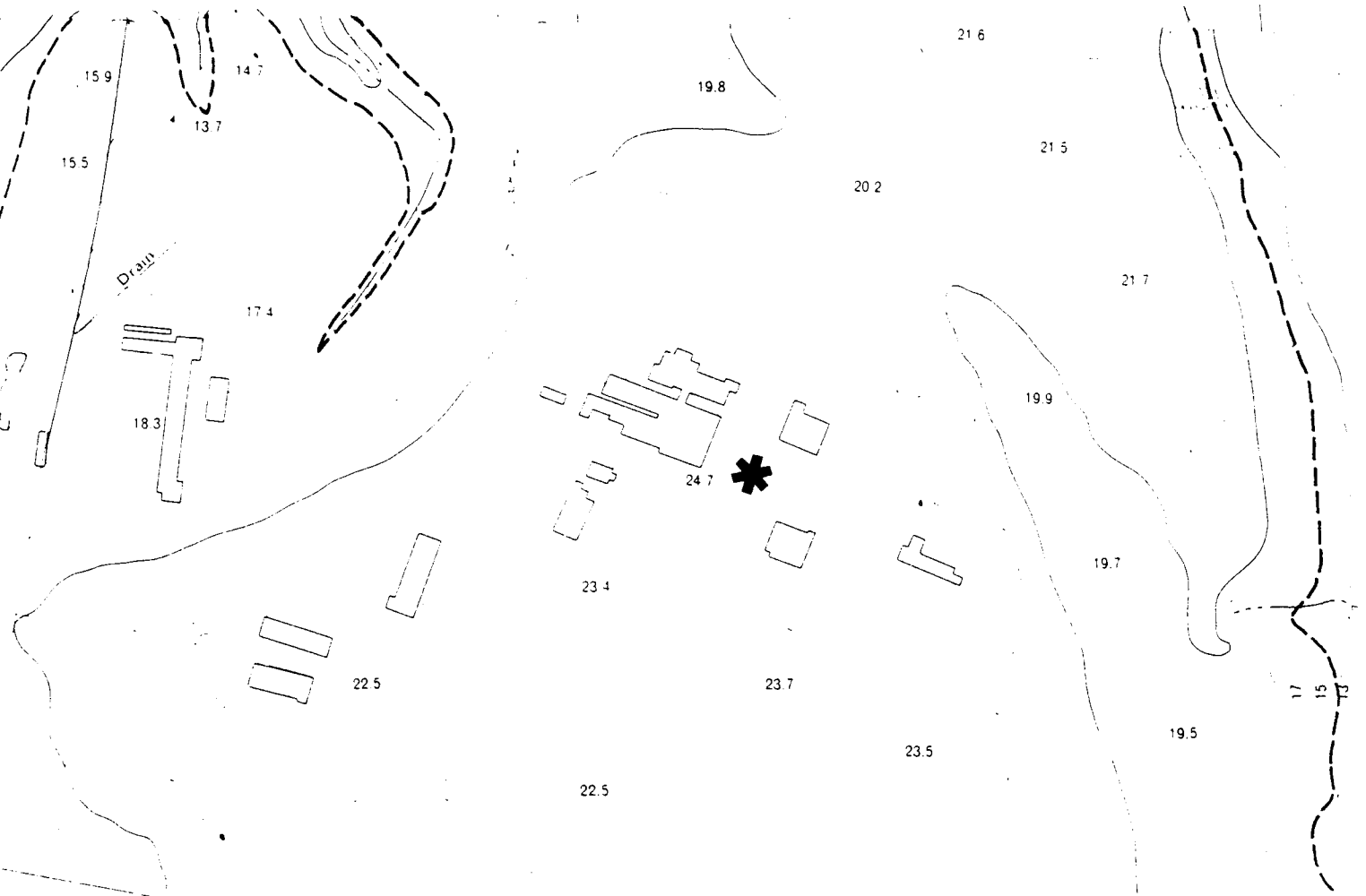

Source: Ipswich City Council. City of Ipswich topographic series. Amended to August 1990. Scale 1:2500. North at top of map. "*" = associated items.

Name Salvation Army Anchorage Farm Precinct

Former/Other Name

Category Precinct

Location 29 Riverview Road, Riverview

RPD L35 M33137 & L1 RP193150 & L2 RP22229 &
L6/7 RP22230 Parish of Goodna

Local Authority Ipswich City Council

AMG Map Sheet SG 56-14, Ipswich **Grid** MQ7645

Present Tenure The Salvation Army Endeavour Anchorage, PO Box 119,
Booval Qld 4304

Listing Boundary Whole of the above allotments, plus adjoining
footpath and including all established trees.

Other Listings**History**

The farm has been used as a home for both migrant boys and juvenile offenders. From 1893, it was a boys' home and its use by English migrants began in 1926. In 1982, it became the first Anchorage Farm for alcoholics in the Australian Eastern territory. The earliest building on the site is believed to be the manager's residence, thought to have been built in the late 1880's to early 1890's. The site's main structure, the hostel building "Canaan", was built afterwards, probably during the early 1890's. A number of original buildings have been lost in the last decade. The blacksmith's shop, used later as a hay shed, located approx. 50m southwest of "Canaan" was recently demolished due to white ant damage. Two assistant manager's residences contemporary to "Canaan" have also been lost - one approx. 80m southwest of "Canaan" demolished due to white ant damage, and one approx. 100m southeast of "Canaan" due to a fire. Accommodation was expanded in the 1950's by the relocation of a Federation style pyramid-roofed house from Bundamba and the construction of barracks adjoining "Canaan". A modern style manager's house has been built on the site in the last few years. River water was the main source of water until the 1950's, with an underground tank installed opposite the present dining room. Potatoes and pumpkins have been the main successful crops of the farm.

Description

In addition to the buildings mentioned in the history above, built on site are a 1920's chapel, a 1940's gymnasium building, various farm-related outbuildings, a substantial entry avenue of mature Bunya pines, and a mature Norfolk pine, planted by Salvation Army founder, General William Booth. The farm complex shows its original open setting, presently being situated in a 126.5 ha site.

Significance **Level** *local* *city* *regional* *Xstate* *national*

- As an institutional site which, including its layout and plantings, remains similar to its turn of the century condition.
- As evidence of social/community service continued by the Salvation Army since 1893 and as a demonstration of the practices of the Salvation Army's religious philosophies.
- For two principal buildings; one is a rare example of a turn of the century institutional building and the other is a rare example of an intact, colonial dwelling.
- As evidence of the migration of English boys.
- As an example of agricultural pursuits in the region.

Significance of Interior

Not applicable

Associated Items

See individual listings for "Canaan", manager's residence, avenue of bunya pines and General Booth's Norfolk pine. The recently completed manager's residence does not require heritage constraints at this time.

Comments

Sources for this report include The War Cry, 4/8/1984 and the present manager. There has been a recent proposal to increase accommodation at the farm by relocating three 1960's barracks from the Salvation Army Riverview Retirement Village immediately to the south of the farm.

Note: This report has been prepared on the basis of evidence examined by the investigator(s) and seeks to identify the most important heritage values of the item. The purpose of this report is to provide an initial evaluation. A conservation study by a qualified practitioner should be completed before any action is taken which may affect the significance of the item.

UQASU IPSWICH HERITAGE STUDY

19 November 1991

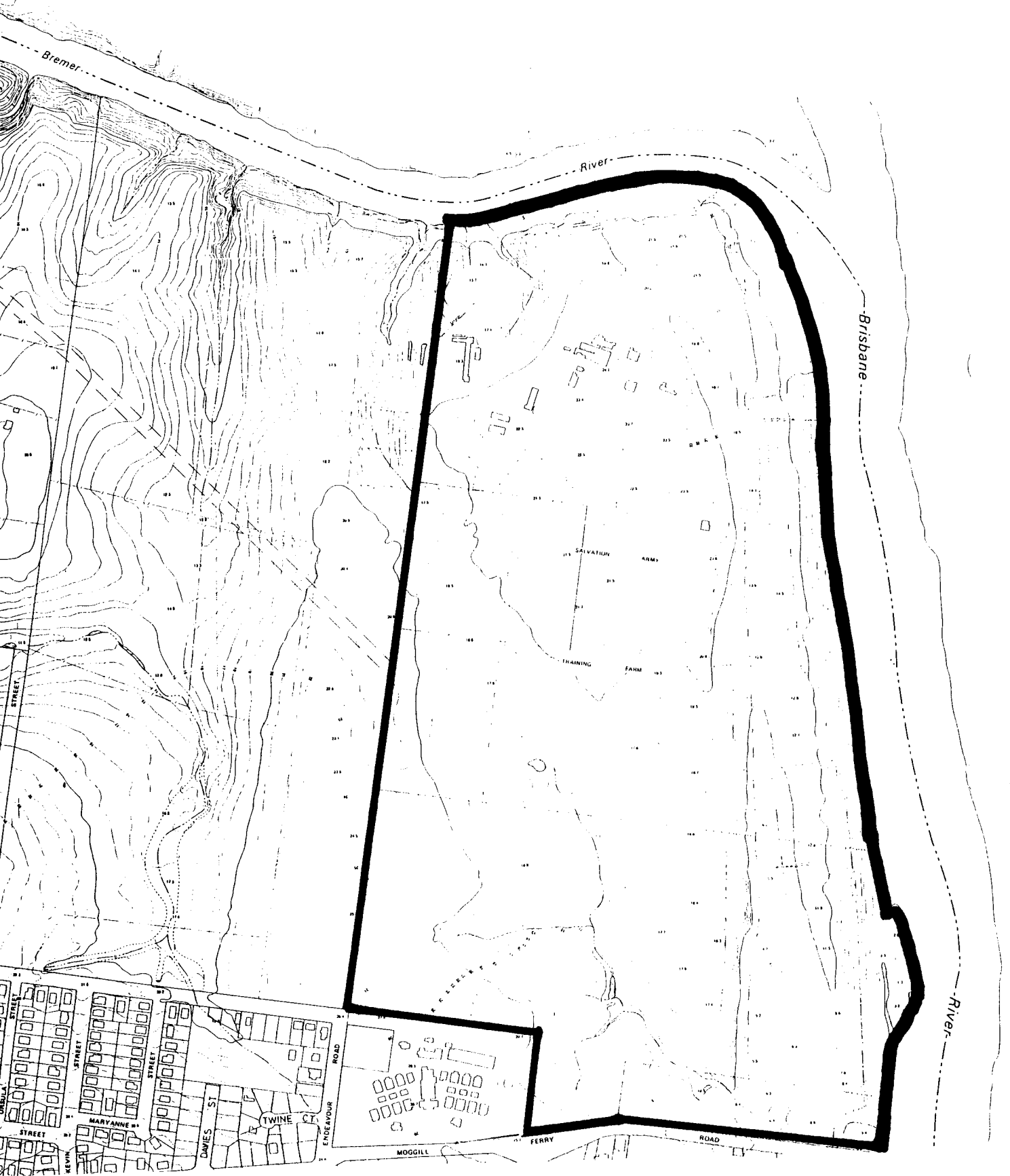

Source: Ipswich City Council. City of Ipswich topographic series. Amended to August 1990. Scale 1:7500. North at top of map. "@" = associated items.

Name 89 Brisbane Road, Riverview

Former/Other Name

Category House

Location 89 Brisbane Road, Riverview

RPD L10 RP87341

Local Authority Ipswich City Council

AMG Map Sheet SG 56-14, Ipswich **Grid** MQ7645

Present Tenure Est T A Sullivan (Dec'd) & Mrs E Sullivan, 89
Brisbane Road, Riverview Qld 4303

Listing Boundary Whole allotment, plus adjoining footpath including
all established trees.

Other Listings**History**

The current owner believes that the house was built at the turn of the century by an Army officer. Originally it was on a larger block of land which was bisected when the present Highway was put through. As late as 1965 there were milking bales on the property.

Description

The structure is a square plan, one storey timber house low set on concrete stumps. It has a corrugated iron, steeply pitched hipped roof. The front and side verandah has a stepped down corrugated iron roof. The verandah has been sheeted in with weatherboards to sill height and blinds infill the space between the chamfered verandah posts. The front verandah has an exposed frame treatment revealing 12" wide horizontal boards. Internally the walls are typically vertical, beaded boards. The corbelled chimney services a double sided fireplace. There has been a rear extension adding a bathroom and extending the kitchen area. The area where the sulky used to be stored at the rear of the house has now been converted to a shower.

Significance	Level	Xlocal	city	regional	state	national
---------------------	--------------	---------------	-------------	-----------------	--------------	-----------------

- As an example of traditional materials, form and details.
-

Significance of Interior

Apart from the more recent extensions, the interior is virtually intact.

Associated Items**Comments**

Historical information supplied by Mrs Sullivan.

Note: This report has been prepared on the basis of evidence examined by the investigator(s) and seeks to identify the most important heritage values of the item. The purpose of this report is to provide an initial evaluation. A conservation study by a qualified practitioner should be completed before any action is taken which may affect the significance of the item.

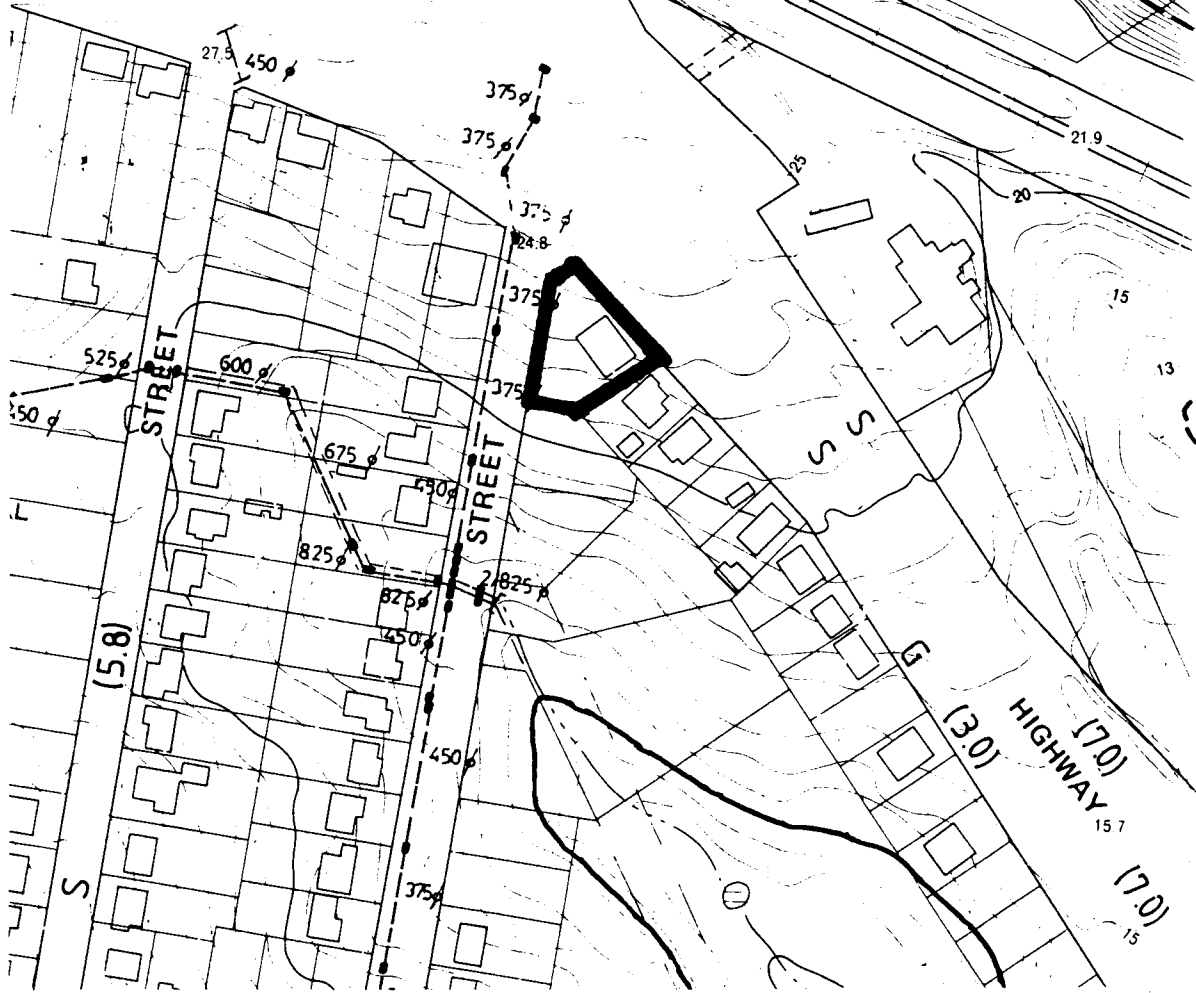

Source: Ipswich City Council. City of Ipswich topographic series. Amended to August 1990. Scale 1:2500. North at top of map. "@" = associated items.

Name 6 Hansell's Parade, Riverview

Former/Other Name

Category House

Location 6 Hansell's Parade, Riverview

RPD L1 SL3211 Par Goodna

Local Authority Ipswich City Council

AMG Map Sheet SG 56-14, Ipswich **Grid** MQ7645

Present Tenure Mr T J Lloyd and Mrs N J Lloyd, 6 Sloman Street, Booval, Qld 4304

Listing Boundary Whole allotment, plus adjoining footpath and including all established trees.

Other Listings**History**

It is thought that the house was relocated back to this site when the present highway was put through. It is presently being used for office purposes.

Description

The house is a square plan, one storey low set timber house set on concrete stumps. It has a pyramid shaped roof of corrugated iron. It features 3 verandahs, with a slightly convex stepped down corrugated iron roof. The verandah walls are lined internally with vertical boards and have exposed nogging and cross bracing. Sash windows overlook the verandah. The verandah uprights are decorated with woodwork brackets, and the balusters are of the dowel type. The baluster portions of the left and right verandahs have been sheeted in and have been enclosed above by louvres. A small set of steps with a metal handrail has been placed at the front entrance.

Significance	Level	Xlocal	city	regional	state	national
---------------------	--------------	---------------	-------------	-----------------	--------------	-----------------

- As an example of Federation materials, form and detail.
-

Significance of Interior Not inspected

Associated Items

House number 12, 22 and 24 Hansell's Parade.

Comments

Historical information on relocation provided by resident of number 12 Hansell's Parade.

Note: This report has been prepared on the basis of evidence examined by the investigator(s) and seeks to identify the most important heritage values of the item. The purpose of this report is to provide an initial evaluation. A conservation study by a qualified practitioner should be completed before any action is taken which may affect the significance of the item.

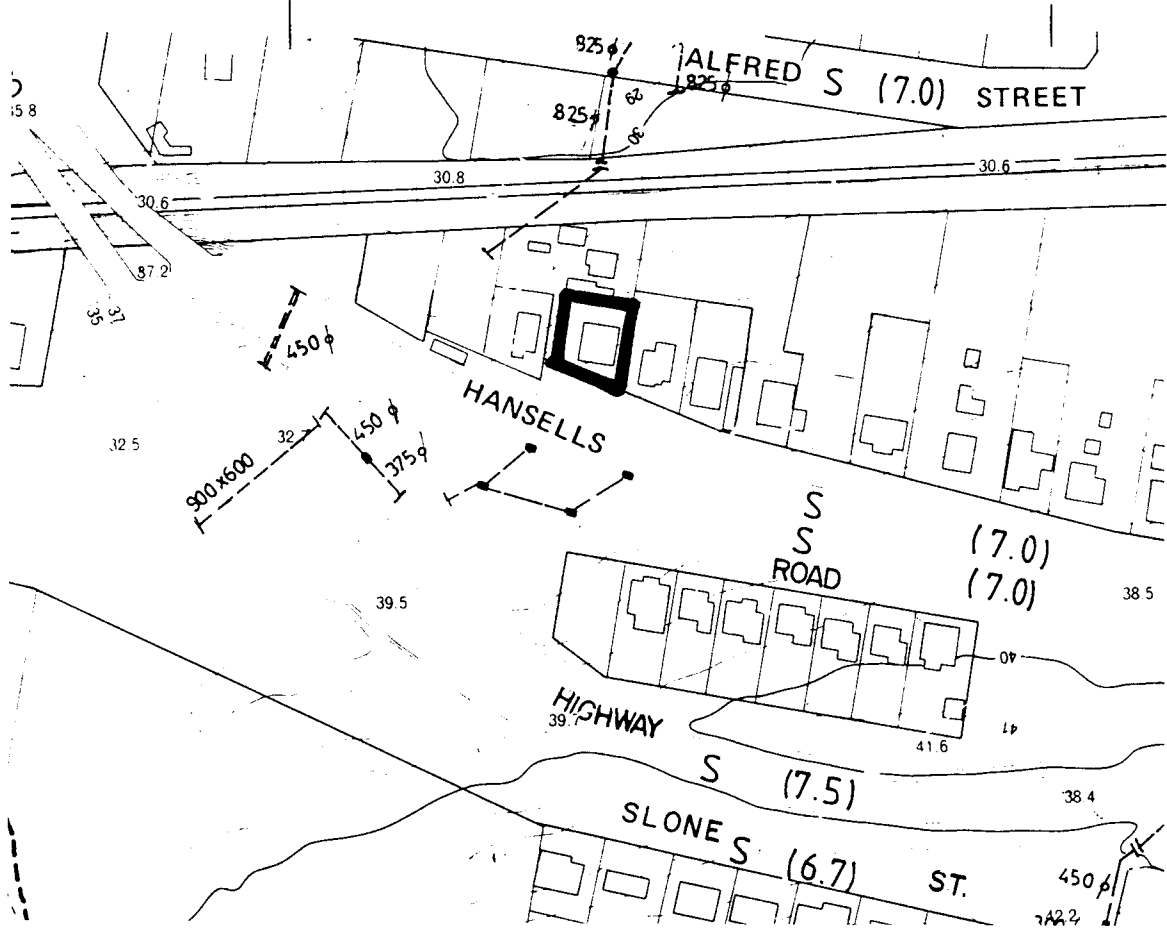

Source: Ipswich City Council. City of Ipswich topographic series. Amended to August 1990. Scale 1:2500. North at top of map. "@" = associated items.

Name 12 Hansell's Parade, Riverview.
 Former/Other Name
 Category House
 Location 12 Hansell's Parade, Riverview.
 RPD L3 RP90693 Par Goodna
 Local Authority Ipswich City Council
 AMG Map Sheet SG 56-14, Ipswich Grid MQ7645
 Present Tenure Mr D W Hedger, 12 Hansell's Parade, Riverview.
 Listing Boundary Whole allotment, plus adjoining footpath and including all established trees.

Other Listings**History**

A present occupant believes that this house along with others in the street was moved back to its present position when the Highway was constructed.

Description

The house is a square plan, one storey, low set timber house on concrete stumps. It has a pyramid shaped roof of corrugated iron. It features 3 verandahs with a slightly convex corrugated iron roof. The verandah walls are lined internally with horizontal boards and have exposed closely spaced vertical studs and some cross bracing. The verandah uprights feature brackets atop, but at the moment there are no balustrades. A small set of wooden stairs without handrails have been placed at the entrance. Plantings include a mango tree.

Significance *Level* *Xlocal* *city* *regional* *state* *national*

- As an example of Federation materials, form and details.
-

Significance of Interior Not inspected

Associated Items

Houses at numbers 6, 22 and 24 Hansell's Parade.

Comments

Note: This report has been prepared on the basis of evidence examined by the investigator(s) and seeks to identify the most important heritage values of the item. The purpose of this report is to provide an initial evaluation. A conservation study by a qualified practitioner should be completed before any action is taken which may affect the significance of the item.

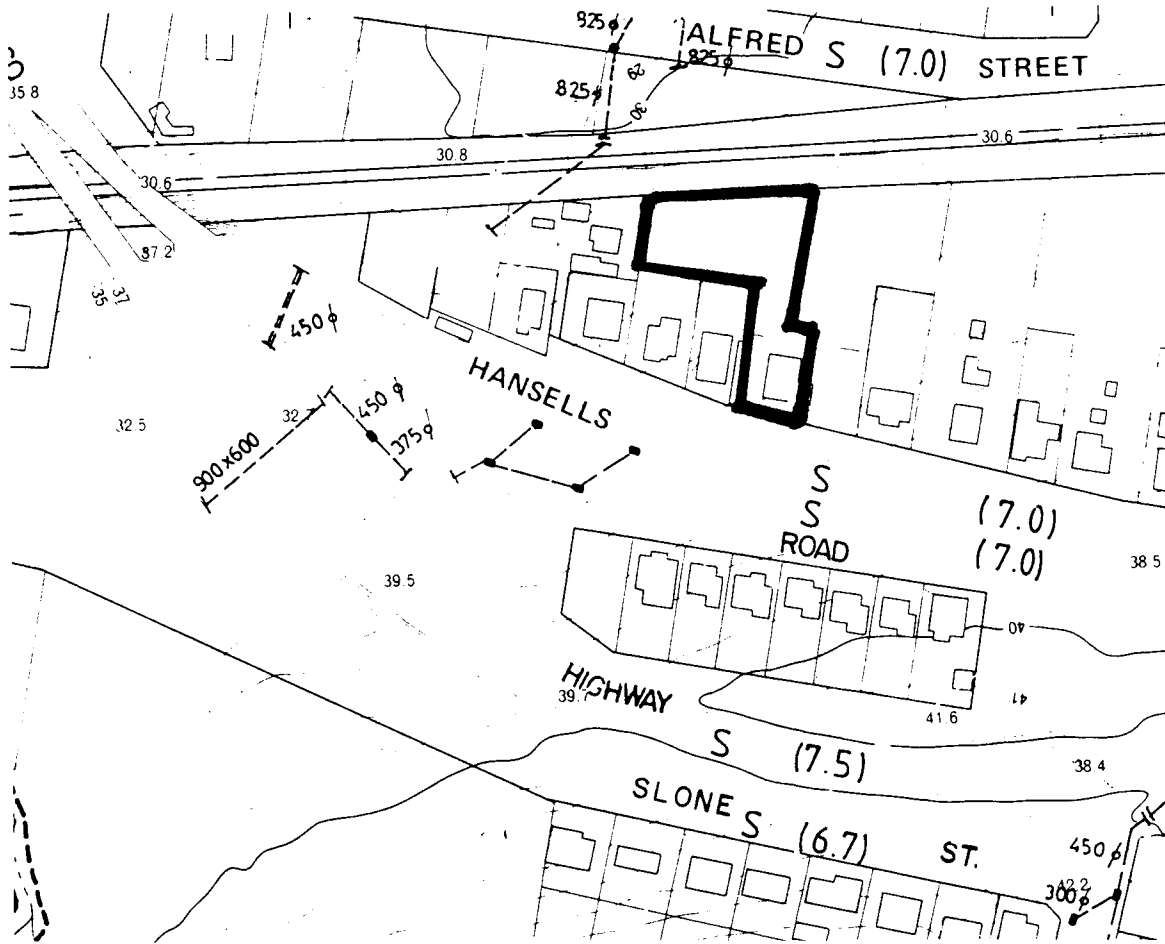

Source: Ipswich City Council. City of Ipswich topographic series. Amended to August 1990. Scale 1:2500. North at top of map. "@" = associated items.

Name 16 Station Road, Riverview Plantings

Former/Other Name

Category Trees

Location 16 Station Road, Riverview

RPD L56/58 RP22329 Par Goodna

Local Authority Ipswich City Council

AMG Map Sheet SG 56-14, Ipswich **Grid** MQ7645

Present Tenure Mr F J and Mrs S C A Goldsbury, 12 Station Road, Riverview Qld 4303

Listing Boundary The greater of the circumference of the canopy or root system.

Other Listings

History

Description

Two mature figs stand at either side of a pyramid roofed timber house. They are clearly visible from the railway station.

Significance **Level** *local* *Xcity* *regional* *state* *national*

- The size of the trees indicates an appreciable age to the settlement.
- For their streetscape value to the local community.

Significance of Interior Not applicable

Associated Items

The pyramid roofed timber house at 16 Station Road, Riverview, featuring a dome-shaped underground water tank.

Comments

Note: This report has been prepared on the basis of evidence examined by the investigator(s) and seeks to identify the most important heritage values of the item. The purpose of this report is to provide an initial evaluation. A conservation study by a qualified practitioner should be completed before any action is taken which may affect the significance of the item.

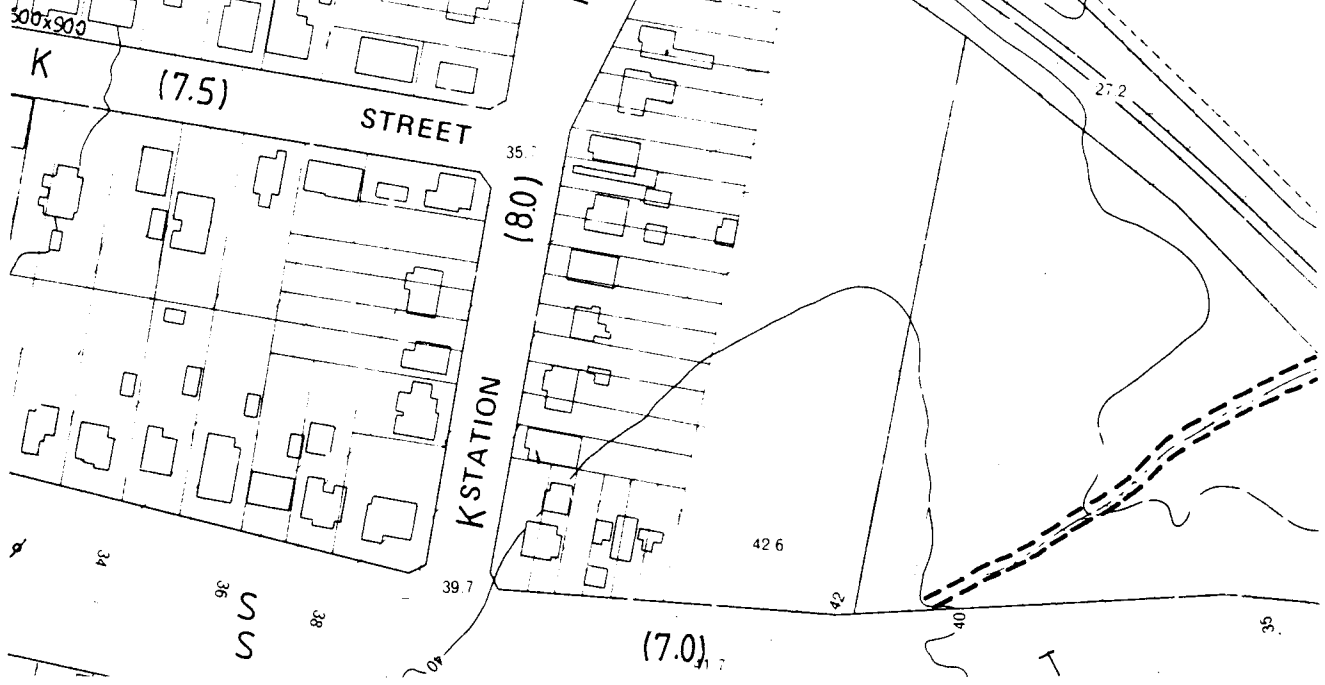

Source: Ipswich City Council. City of Ipswich topographic series. Amended to August 1990. Scale 1:2500. North at top of map. "@" = associated items.