

RACEVIEW CITATIONS
Table of Contents

Aberdare Extended No 1 Colliery	14 Owen Street
American War Cemetery Memorial	Manson Park, 19 Cemetery Road
Grain Silos	32 Taylor Street
House	8 Hayes Street
Tree	102 Wildey Street
House	185 Wildey Street

Name Aberdare Extended No.1 Colliery
Former/Other Name

Category Historic Mining Complex

Location 14 Owen Street, Raceview 4305

RPD Lot 3 RP22476, Lot 8 RP166551 & Lot 1 RP168737, Par Goodna; Lot 19 & 30/31 RP112475, Lot 1 RP180890 & Lot 1 RP1, Par Ipswich, Co Stanley

Local Authority Ipswich City Council

AMG Map Sheet SG 56-14, Ipswich **Grid** MQ7645

Present Tenure Mrs J C Toft
14 Owen Street, Raceview Q 4305

Listing Boundary All land circumscribed on the accompanying map east of the highway and adjoining Bundamba Creek.

Other Listings -

History

Opened by the Walker Bros in 1909 the Aberdare Extended No. 1 Mine became the hub of their coal mining operations. The shaft reached the Aberdare Seam at 200 m. A head frame 18 m in height was constructed and an electricity power station was developed that in 1913 was the largest in the district. The mine was the first in Queensland to use a panel system of working with traditional bord and pillar techniques of extraction. By 1923 coal was being raised at a rate of 300 tonnes per day, making it Walkers' largest single operation. The mine was closed in 1946.

Description

The most conspicuous remnant is a small brick building on an arched concrete supporting base with a brick chimney and a corrugated galvanised iron roof which was used as the timekeeper's office. The interior of the building is divided into two rooms with the walls cemented and a bath set into one corner of the smaller room. A stove is positioned beneath the chimney in the main room. There are doors in the northwest and southeast walls and windows in the northeast and southeast walls. The building is in a fair state of preservation.

There are also substantial brick concrete and timber remains of the services installation including ventilation fan mount area, engine room for power generation including engine blocks, power board and power pole remains. There is considerable evidence of other concrete structures and numerous buildings are delineated by the sets of timber stumps remaining.

Significance **Level** *local* *Xcity* *regional* *state* *national*

- An important local colliery from 1910 to 1946.
- The only known remnant of the Walker Bros. group of mines.
- A well preserved small brick building serving as a living/working area for a coal mine employee.

Significance of Interior Not applicable

Associated Items Railway siding from the Bundamba - Redbank loopline

Comments

The colliery is situated in a conspicuous, easily accessible position beside the Warwick bypass. A detailed industrial archaeological recording and interpretation of the site is required.

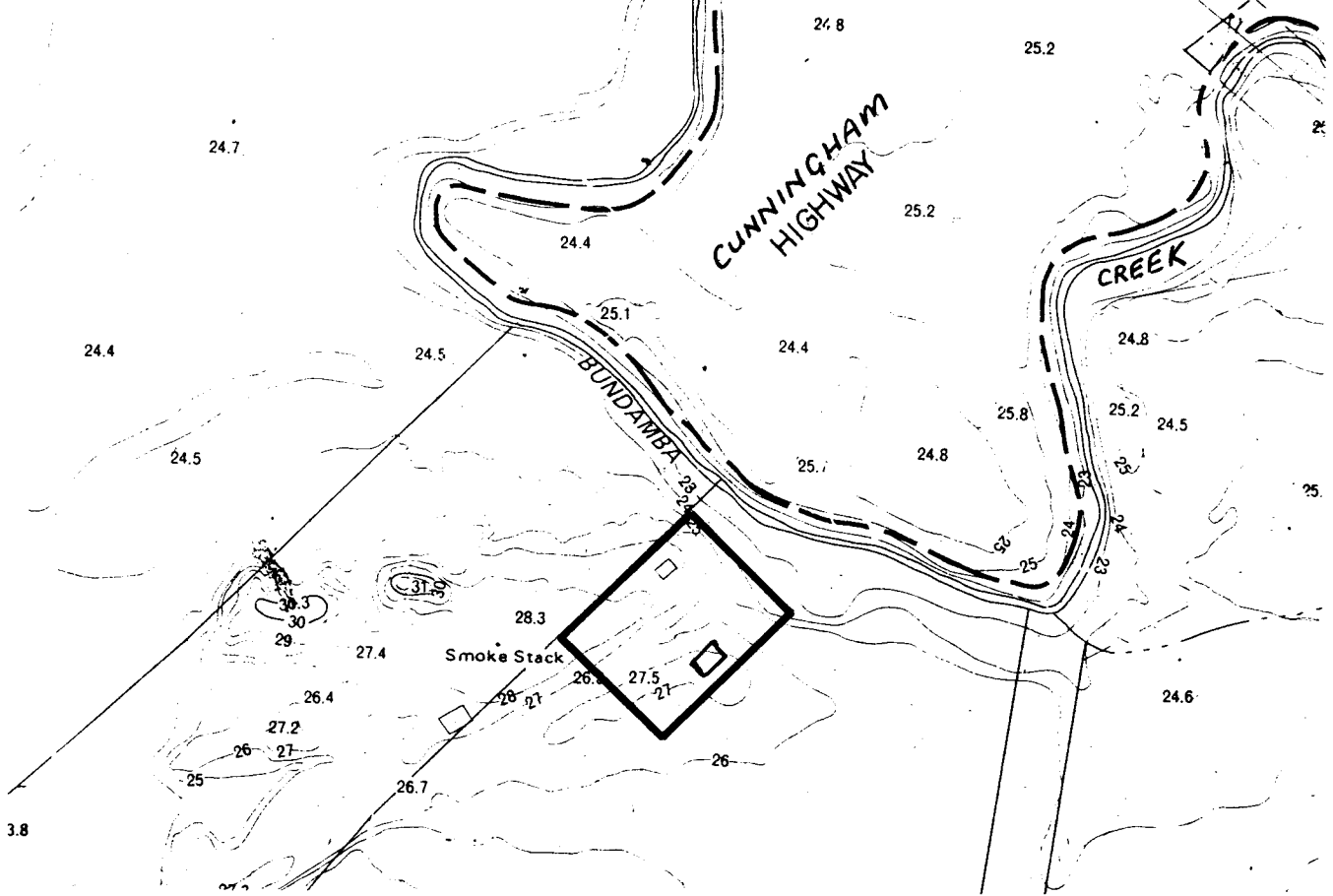

Source: Ipswich City Council. City of Ipswich topographic series. Amended to August 1990. Scale 1:2500. North to top of map.

Name American War Cemetery Memorial
Former/Other Name
Category Memorial
Location Manson Park, 19 Cemetery Road, Raceview
RPD Reserve 4259 - L1 I16249 Par Ipswich
Local Authority Ipswich City Council
AMG Map Sheet SG 56-14, Ipswich **Grid** MQ7645
Present Tenure Ipswich City Council as Trustee, 50 South Street, Ipswich Qld 4035
Listing Boundary Whole allotment, plus adjoining footpath and including all established trees.
Other Listings

History

During World War II, many American servicemen died or were killed in Australia or the surrounding area. A contract was drawn up between the United States Government and the Ipswich Cemetery Trust which stated that the servicemen were to be buried in the special cemetery reserve, 'for the duration of the war plus six months afterwards or for a period of ten years whichever is the lesser'. The final number of burials was 1260, but there were a number of unknown graves. On 17 November, 1947, the United States ship 'Gauchee Victory' arrived in Australia to return the American dead to their native country. To exhume the bodies, 190 Australian civilians, said to be mainly cane-cutters, were employed. One of the Depot buildings at the Redbank Army Camp, listed separately, was used as a morgue. The original cemetery reserve, no. 1459, stretched from Orchard Street to Whitehill Road, but the present Manson Park represents only a westerly portion. As early as 1951 a fund was established at Ipswich for a memorial to fallen US servicemen who were interred in Ipswich. In 1971 the Council developed the park. The name of the park pays tribute to a local woman, Mrs Manson, who cared for the graves during the war. A memorial to 'honour American servicemen who paid the supreme sacrifice during World War II' was unveiled by Major J A Watson, USAF, on Anzac Day, 25 April 1971.

Description

The sparsely planted park is dominated by the memorial. It consists of an octagonal painted concrete pedestal standing on a stepped circular concrete base, surmounted by a metal flagstaff.

Significance **Level** *X*local city regional state national

- As evidence of the patriotic sentiments of the local community in the latter half of the twentieth century

Significance of Interior Not inspected

Associated Items**Comments**

It is recommended that the Park be formally reserved for memorial purposes. Historical information from Robyn Buchanan article, *Queensland Times*, 9/12/1985.

Note: This report has been prepared on the basis of evidence examined by the investigator(s) and seeks to identify the most important heritage values of the item. The purpose of this report is to provide an initial evaluation. A conservation study by a qualified practitioner should be completed before any action is taken which may affect the significance of the item.

Name The Grain Silos
Former/Other Name
Category Silos
Location 32 Taylor Street, Raceview
RPD L33 RP95056 Par Ipswich
Local Authority Ipswich City Council
AMG Map Sheet SG 56-14, Ipswich **Grid** MQ7645
Present Tenure Boy Scouts Association, PO Box 334, Booval Qld 4304
Listing Boundary Intersecting lines, two metres from the present external walls, as approximated on the accompanying map.
Other Listings

History

The silos and the land on which they are situated was once part of a cattle farm owned by Vivian Hancock and his wife May. Their property totalled 50 acres. On leaving Ipswich in the early 1960's, they subdivided the property and donated lots to each of the Roman Catholic, Anglican and Presbyterian Churches. They also donated 5 acres with their farm house along with the orchard, tennis courts and fernery, to the Blue Nurses. With this land, the Blue Nurses established 'Lauriston' at 15 Robertson Road, Raceview, believed to be the first Blue Nurses' home. The silos and land was donated to the Scout Association. The silos were used to store hay and the grain feed for the cattle on the farm. It is believed that these silos are still in their original form, though an addition has been made to the side. Presently, it is used as a scout den and office space.

Description

This is a group of four silos situated to the west of the present scout hut. Two pairs sit adjacent, with a corrugated iron, polygonal ended roof covering each pair. Each silo has an exposed frame, and has internal corrugated sheeting. There has been a corrugated iron, skillion roofed enclosure between the two pairs, and to the east a large, skillion roofed corrugated iron addition sloping towards the present scout hut.

Significance *Level* *Xlocal* *city* *regional* *state* *national*

- For its associations with the farming and pastoral history of the area
- For its association with the Hancock family and their contributions to the local community

Significance of Interior Not inspected

Associated Items

Comments

Historical information supplied by Mr R Prince, Ms V Cribb and Mrs M Hancock.

Note: This report has been prepared on the basis of evidence examined by the investigator(s) and seeks to identify the most important heritage values of the item. The purpose of this report is to provide an initial evaluation. A conservation study by a qualified practitioner should be completed before any action is taken which may affect the significance of the item.

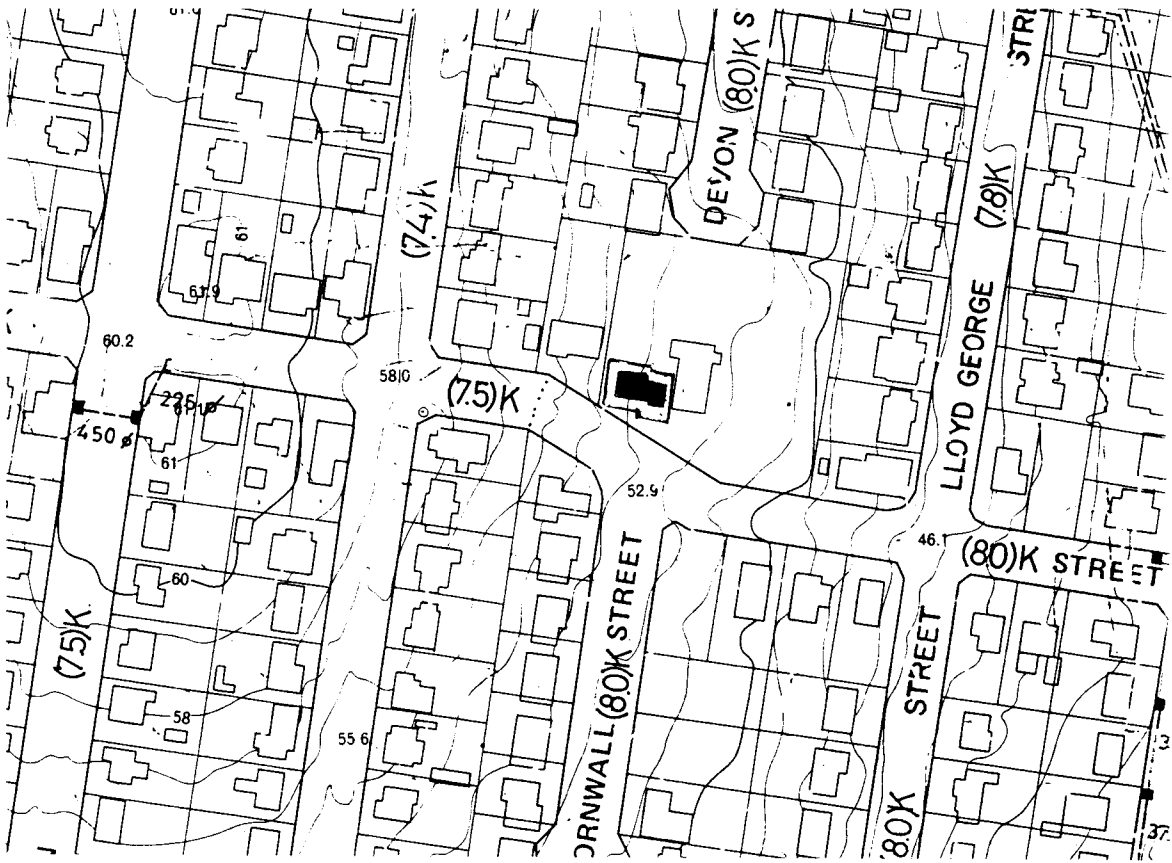

Source: Ipswich City Council. City of Ipswich topographic series. Amended to August 1990. Scale 1:2500. North at top of map. "@" = associated items.

Name 8 Hayes Street, Raceview

Former/Other Name

Category House

Location 8 Hayes Street, Raceview

RPD L44/45 RP67693 (to depth 100') Par Ipswich

Local Authority Ipswich City Council

AMG Map Sheet SG 56-14, Ipswich **Grid** MQ7645

Present Tenure Mr B R Tills, 8 Hayes Street, Raceview Qld 4305

Listing Boundary Whole allotment, plus adjoining footpath and including all established trees.

Other Listings

History

A present neighbour, Mr D Hayes, grew up in the house. He believes that it may have been relocated to this site from Boonah - Kalbar area at the very beginning of this century. The Grange racecourse used to be at the end of Hayes Street, in the Raceview Road area, and previously there were stables across the street from the house. The large block of land upon which the house sat was subdivided in the 1960's, and the surrounding streets are thought to reflect the original easements and carriageways around the house.

Description

This low set, timber house presently sits on a high position which would have previously afforded extensive views, and is parallel to the present Hayes Street. The main roof is a corrugated iron, moderately pitched pyramid, which is extended at the southeasterly corner by a long hipped projection. The stepped down slightly convex verandah roof wraps around the house. The verandah walls have an exposed frame, featuring cross bracing, and french doors and a panelled front door lead onto the wider than usual verandah. There is a small circular depression surrounded by stones, in the front garden, which is thought may have once been a well to supply water to the house.

Significance **Level** *x*local city regional state national

- For its associations with the agricultural history of the area
- As an example of traditional materials, form and detail

Significance of Interior Not inspected

Associated Items**Comments**

Historical information from the present owner and Mr D Hayes.

Note: This report has been prepared on the basis of evidence examined by the investigator(s) and seeks to identify the most important heritage values of the item. The purpose of this report is to provide an initial evaluation. A conservation study by a qualified practitioner should be completed before any action is taken which may affect the significance of the item.

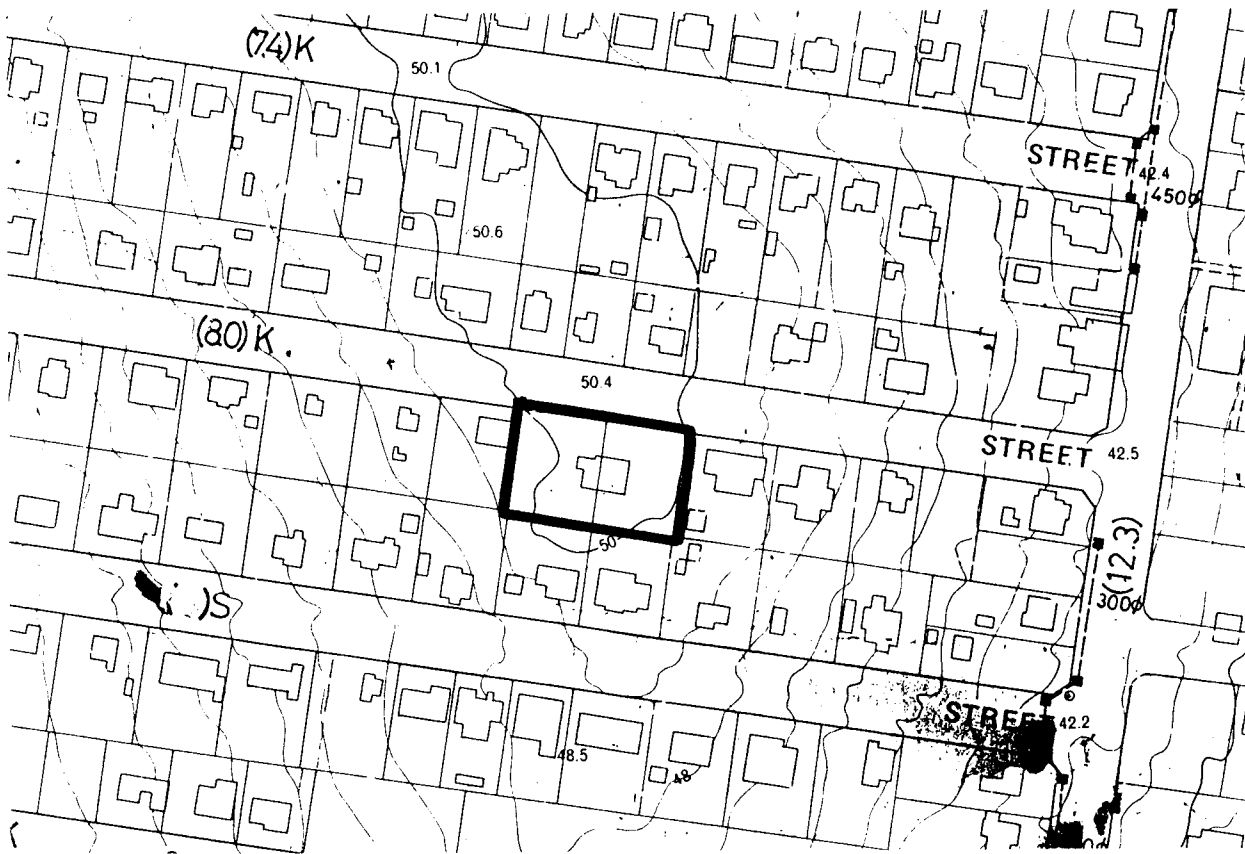

Source: Ipswich City Council. City of Ipswich topographic series. Amended to August 1990. Scale 1:2500. North at top of map. "@" = associated items.

Name 102 Wildey Street, Raceview Plantings

Former/Other Name

Category Tree

Location 102 Wildey Street, Raceview

RPD L3 RP96509 (to depth 100') Par Ipswich

Local Authority Ipswich City Council

AMG Map Sheet SG 56-14, Ipswich **Grid** MQ7645

Present Tenure Mr W R Johnston, 102 Wildey Street, Raceview Qld 4305

Listing Boundary The greater of the circumference of the canopy or root system.

Other Listings**History**

The current owners believe that the house on the property may have been an original farm house, built around the very beginning of this century.

Description

This poinciana tree dominates the corner of Raceview Road and Butler Street. Its spreading, massive canopy is massive, and almost shields the house from view.

Significance	Level	<i>local</i>	<i>Xcity</i>	<i>regional</i>	<i>state</i>	<i>national</i>
•	Its mature form reflects the time depth of settlement in the area.					
•	For its streetscape value					

Significance of Interior Not inspected

Associated Items**Comments**

Note: This report has been prepared on the basis of evidence examined by the investigator(s) and seeks to identify the most important heritage values of the item. The purpose of this report is to provide an initial evaluation. A conservation study by a qualified practitioner should be completed before any action is taken which may affect the significance of the item.

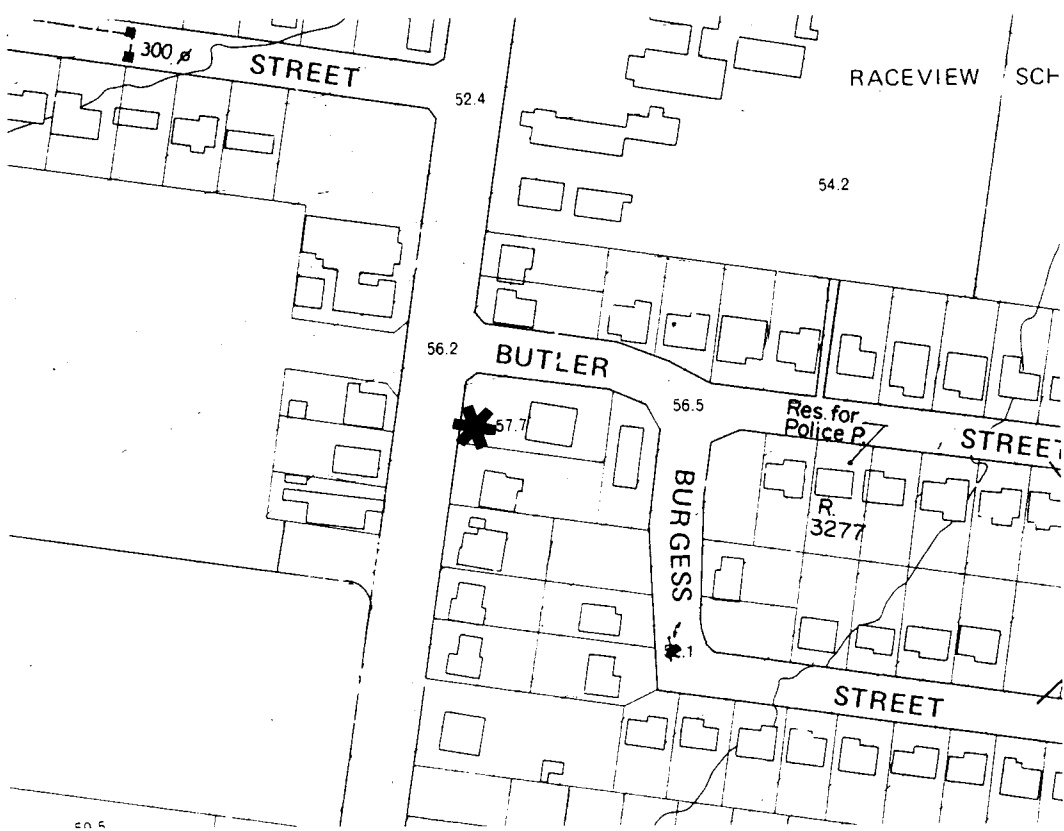

Source: Ipswich City Council. City of Ipswich topographic series. Amended to August 1990. Scale 1:2500. North at top of map. "*" = associated items.

Name 185 Wildey Street, Raceview
Former/Other Name
Category House
Location 185 Wildey Street, Raceview
RPD L1 RP64061 Par Ipswich
Local Authority Ipswich City Council
AMG Map Sheet SG 56-14, Ipswich **Grid** MQ7645
Present Tenure Miss I Marsh, 189 Wildey Street, Raceview Qld 4305
Listing Boundary Whole allotment, plus adjoining footpath and including all established trees.
Other Listings

History

The house was built around 1910 by John Marsh. Originally from Bristol, John Marsh settled on the property around 1854, and started the first orchard in the local area. John Marsh grew a large variety of fruit, and sent his fruit to Brisbane by boat. The family also had bee hives and processed grape wine and preserved fruits on the property. Most of the fruit trees are gone now; those that are still there are no longer bearing fruit. The property originally stood on 12 acres and was subdivided when the children married. A son received the top half, and the daughter the lower. William, the eldest son of John Marsh, is credited with having started Ipswich's first nursery at Short Street, Ipswich.

Description

This is a square plan, one storey timber house, low set on timber stumps well back from the front alignment. Its pyramid roof is of corrugated iron, as is the stepped down, convex front verandah roof. The main roof gutters have decorative metal pieces standing up on the corners. Its external walls are lined with chamferboard, whilst the front verandah walls are lined internally with vertical boards with an exposed frame featuring cross bracing and nogging. Timber detailing on the front verandah includes dowelled balustrading, moulded capitals and paired fretwork brackets on chamfered verandah uprights. The scene is completed with a small timber fence placed close to the house, well back from the street alignment.

Significance **Level** *X*local city regional state national

- As an example of traditional materials, form and detail.
- For its historic associations with the Marsh family, who established early orchard and nursery businesses

Significance of Interior Not inspected

Associated Items**Comments**

Historical information supplied by Mr Marsh.

Note: This report has been prepared on the basis of evidence examined by the investigator(s) and seeks to identify the most important heritage values of the item. The purpose of this report is to provide an initial evaluation. A conservation study by a qualified practitioner should be completed before any action is taken which may affect the significance of the item.

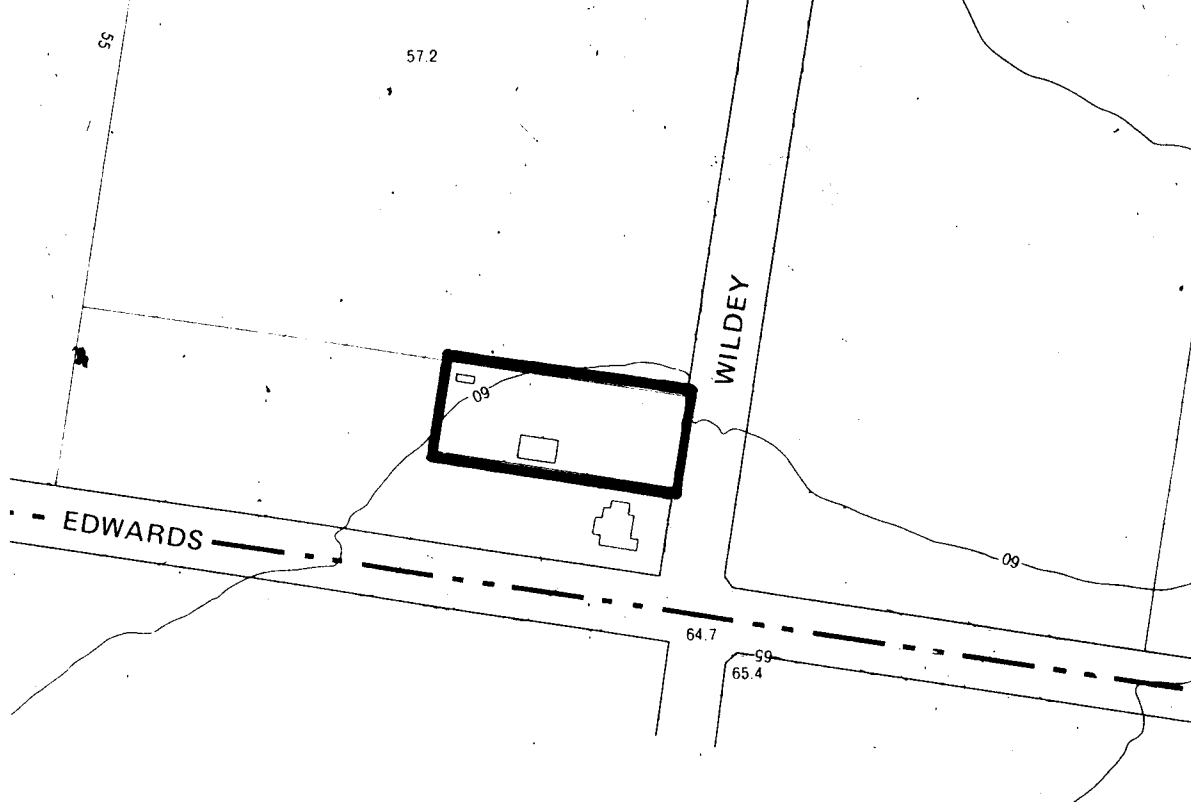

Source: Ipswich City Council. City of Ipswich topographic series. Amended to August 1990. Scale 1:2500. North at top of map. "@" = associated items.