

BASIN POCKET CITATIONS
Table of Contents

House	65 Blackall Street
House	100 Blackall Street
House	102 Blackall Street
Ferryman' Cottage	36 Davidson Street
House	9 Grenville Street
H J Harper Band Hall	64 Blackall Street
Villa Esrum	13 McGill Street

Name 65 Blackall Street, Basin Pocket
Former/Other Name
Category House
Location 65 Blackall Street, Basin Pocket
RPD L1/2 RP24015 Par Ipswich
Local Authority Ipswich City Council
AMG Map Sheet SG 56-14, Ipswich **Grid** MQ7645
Present Tenure Mr C T Wolter & Ms P M Follett, 65 Blackall Street, Basin Pocket Qld 4305
Listing Boundary Whole allotment, plus adjoining footpath and including all established trees.
Other Listings

History

The following information supplied by one of the present occupants, Mrs Wolter, was obtained from a relative of a woman who used to own the house. The house was a worker's cottage, apparently one of the first built on the street, and is estimated to have been built around 1880/1890. The home originally had three bedrooms and a sitting room. On one side, a lean-to was attached which was the pantry cum scullery, and on the other side, a bedroom was attached. The original kitchen and dining room were in a rear detached structure, as was a wash house. What was the original front verandah is now the sitting room, the original kitchen is now a bedroom, while the scullery is the present kitchen. The original wash house has been converted into the toilet and shower, and still remains separate from the house.

Description

This is a basically square plan that is a low set one storey timber house set close to the front alignment. The pyramid roof is of corrugated iron, as is the rear left pyramid roof projection. The slightly convex, corrugated iron verandah roof wraps around the front and sides. The front verandah wall is lined internally with horizontal boards and exposed closely set studs and cross bracing. The verandah at the front has been enclosed to sill height with lattice panels, and to the side these lattice panels infill the space between the verandah posts. The setting has been enhanced by plantings close to the front fence, which is composed of metal uprights and metal wire spans.

Significance **Level** *X*local city regional state national

• As an example of traditional colonial materials and their form.

Significance of Interior Not inspected

Associated Items**Comments**

Historical information supplied by present owner Mrs Wolter.

Note: This report has been prepared on the basis of evidence examined by the investigator(s) and seeks to identify the most important heritage values of the item. The purpose of this report is to provide an initial evaluation. A conservation study by a qualified practitioner should be completed before any action is taken which may affect the significance of the item.

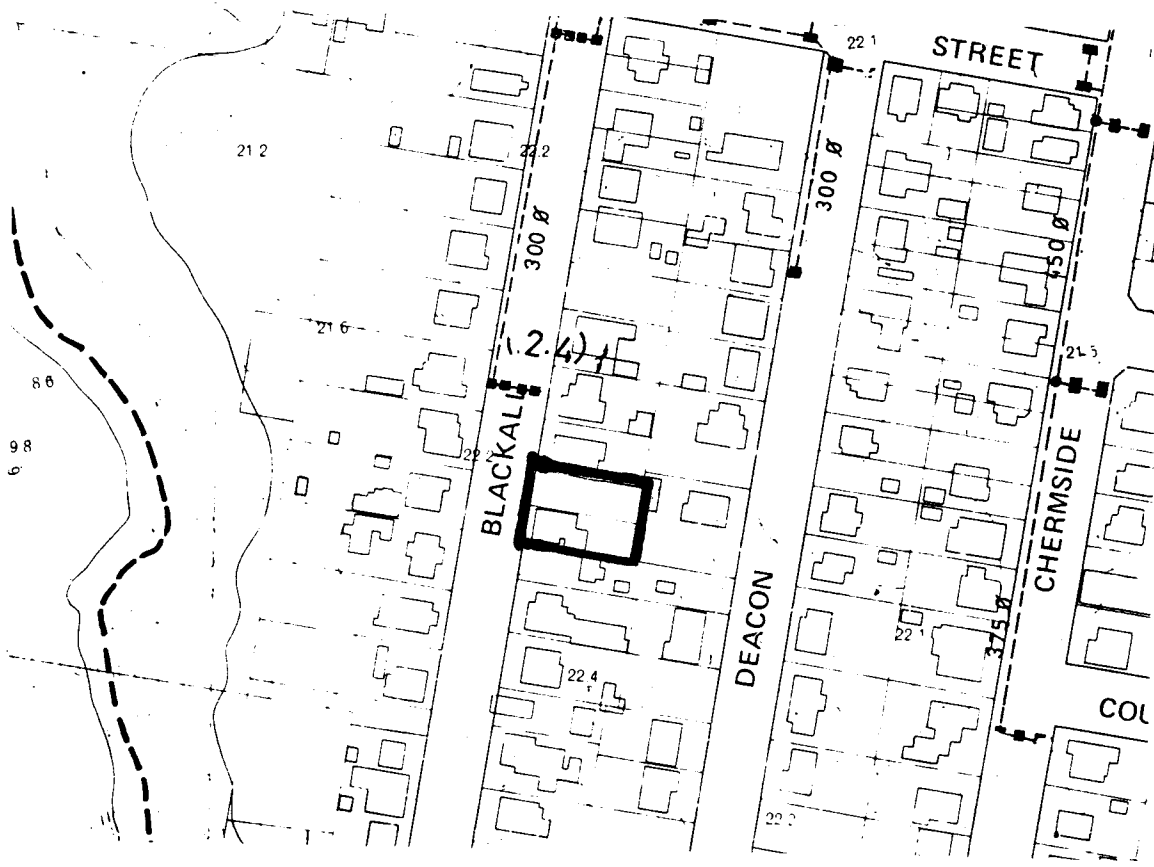

Source: Ipswich City Council. City of Ipswich topographic series. Amended to August 1990. Scale 1:2500. North at top of map. "@" = associated items.

Name 100 Blackall Street, Basin Pocket

Former/Other Name

Category House

Location 100 Blackall Street, Basin Pocket

RPD L31 RP23986 Par Ipswich

Local Authority Ipswich City Council

AMG Map Sheet SG 56-14, Ipswich Grid MQ7645

Present Tenure Mrs E M Holworth, 100 Blackall Street, Basin Pocket Qld 4305

Listing Boundary Whole allotment, plus adjoining footpath and including all established trees.

Other Listings

History

Basin Pocket has traditionally been the home to workers from the Railway Workshops and the now demolished East Ipswich Woollen Mill. The present owner moved into it on marriage.

Description

This is a one storey weatherboard house, moderately high set on timber stumps. It has a moderately pitched corrugated iron pyramid roof which runs continuously with a rear right projection. There is a small, weatherboard skillion roofed addition to this rear projection. The stepped down, front verandah roof is also of corrugated iron, and slightly convex. The front verandah walls are lined internally with vertical board and have exposed noggings. The railing features dowel balusters, and other verandah detailing includes moulded capitals and fretworks brackets on the chamfered timber verandah posts. The house has sash windows, and those on the external walls are covered by decorative tin hoods. The front stairs have metal handrails and balusters and lead to a pair of timber curved top, verandah entry gates, with lattice panels below doorknob height and chamfered timber above.

Significance	Level	Local	city	regional	state	national
--------------	-------	-------	------	----------	-------	----------

- As an example of traditional materials, form and detailing.
- As an example of modest worker housing.

Significance of Interior Not inspected.

Associated Items

This modest worker's dwelling is complemented by the adjacent cottage at 102 Blackall Street.

Comments

Historical information supplied by local resident Mr T Lawrence and present owner Mrs J Ross.

Note: This report has been prepared on the basis of evidence examined by the investigator(s) and seeks to identify the most important heritage values of the item. The purpose of this report is to provide an initial evaluation. A conservation study by a qualified practitioner should be completed before any action is taken which may affect the significance of the item.

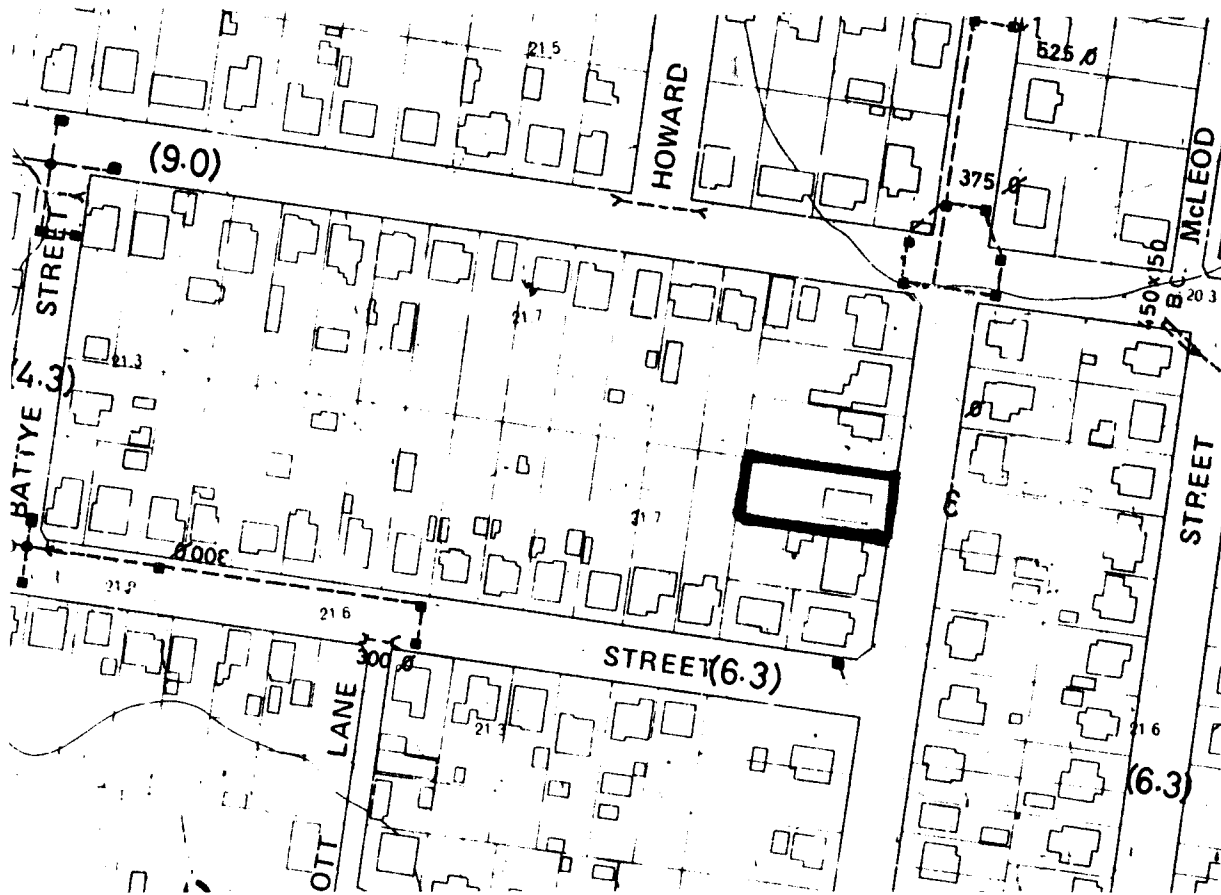

Source: Ipswich City Council. City of Ipswich topographic series. Amended to August 1990. Scale 1:2500. North at top of map. "@" = associated items.

Name 102 Blackall Street, Basin Pocket

Former/Other Name

Category Cottage

Location 102 Blackall Street, Basin Pocket

RPD L32 RP23986 Par Ipswich

Local Authority Ipswich City Council

AMG Map Sheet SG 56-14, Ipswich **Grid** MQ7645

Present Tenure Messrs D J Hanson & E W Bangrove, 22 Grenville Street, Basin Pocket Qld 4305

Listing Boundary Whole allotment, plus adjoining footpath and including all established trees.

Other Listings**History**

Basin Pocket has traditionally been the home to workers from the Railway Workshops and the now demolished East Ipswich Woollen Mill.

Description

This is a square plan, one storey weatherboard cottage that is high set on timber stumps. It is a gable ended structure with a steeply pitched corrugated iron roof, and typically would have originally been a two roomed cottage, with front and back verandah. The corrugated iron roof lessens its pitch over the verandah areas. The verandah at the rear is now enclosed, a common response to enlarging such cottages to meet modern living requirements. The front verandah remains open, and its front wall is unlined, exposing cross bracing and horizontal boards. French doors lead onto the front verandah, otherwise there are small sash windows on the side walls. The timber verandah posts are plain, and features a series of three horizontal timber battens to handrail height. The subfloor space has been sheeted in under the main and rear verandah sections. This very typical colonial style home is unusual in not being set low to the ground. It is supposed that the house has been deliberately raised at some time.

Significance **Level** *Xlocal* *city* *regional* *state* *national*

- As an example of traditional colonial materials, form and plain detailing.
- As an example of modest worker housing.

Significance of Interior Not inspected

Associated Items

This cottage is complemented by the square example of modest worker's dwellings adjacent at 104 Blackall Street, which is listed separately.

Comments

Historical information supplied by local resident Mr T Lawrence.

Note: This report has been prepared on the basis of evidence examined by the investigator(s) and seeks to identify the most important heritage values of the item. The purpose of this report is to provide an initial evaluation. A conservation study by a qualified practitioner should be completed before any action is taken which may affect the significance of the item.

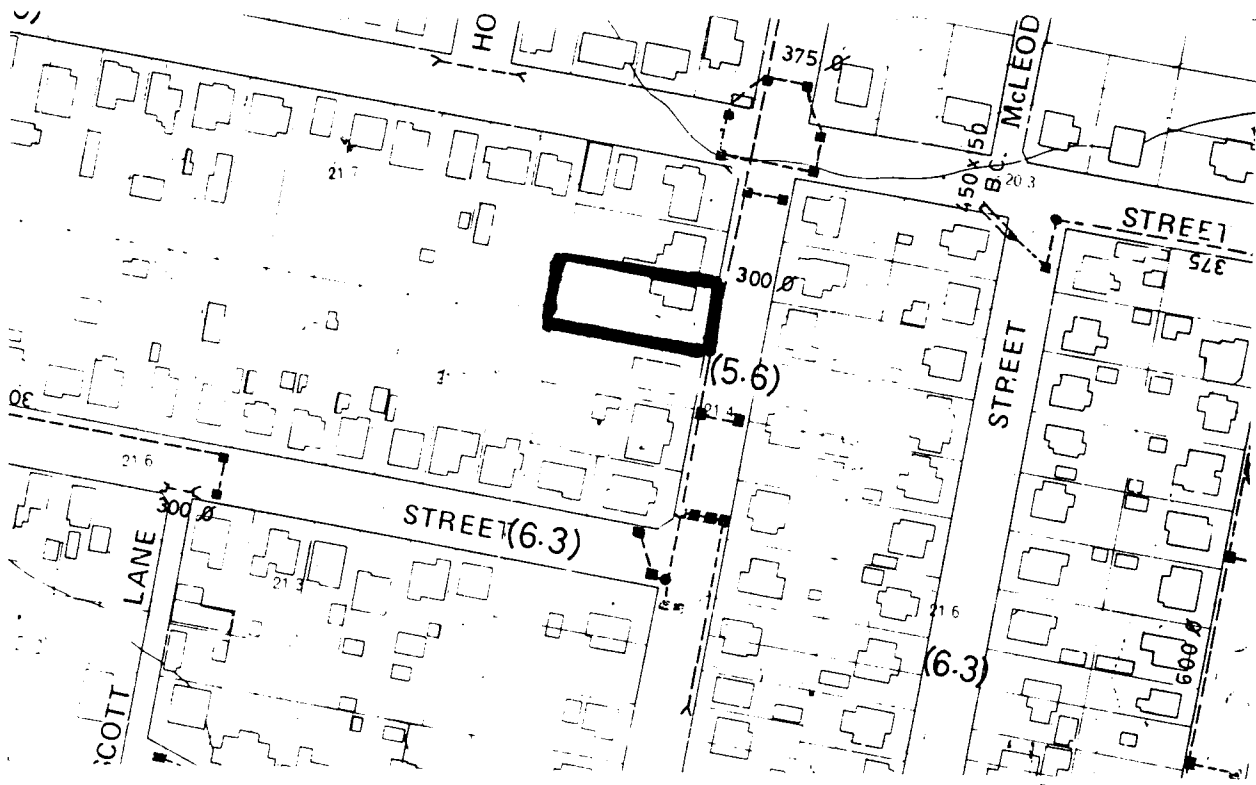

Source: Ipswich City Council. City of Ipswich topographic series. Amended to August 1990. Scale 1:2500. North at top of map. "@" = associated items.

Name Ferryman's cottage

Former/Other Name

Category Cottage

Location 36 Davidson Street, Basin Pocket

RPD L21 RP23979 (to depth 70') Par Ipswich

Local Authority Ipswich City Council

AMG Map Sheet SG 56-14, Ipswich **Grid** MQ7645

Present Tenure Ms J F Ward, 36 Davidson Street, Basin Pocket Qld 4305

Listing Boundary Whole allotment, plus adjoining footpath and including all established trees.

History

The ferry service which ran between the end of Davidson Street Basin Pocket and Bank Street North Ipswich, was provided primarily to allow railway workers to travel daily during the week to the North Ipswich Railway Workshops. Children also used the ferry to attend North Ipswich State School, and women used it to go shopping in North Ipswich. There was some subsidy on the fare by the Council, but passengers were still required to meet some of the costs. The original ferryman, William Isaac Lawrence built and maintained a jetty at the end of Davidson Street and also built two punts with which he used to row his passengers across the river. At times when the water hyacinth was too thick, two steel cables would be stretched across the river, and he would pull his punt across. The ferry run was taken over by a Mr Wraight, but closed just after World War II when the competition from buses became too great. This cottage was built by Mr Lawrence at the southern end of Davidson Street on the first rise just back from the river's edge. When the problem with flooding on that site became apparent, he took the cottage apart board by board and carried them up on his back to this present site for re-erection.

Description

This is a rectangular plan, one storey, low set, gable ended structure. It has a moderately pitched corrugated iron roof which runs continuously but at a lesser angle over the now enclosed front and rear verandahs. It appears that it has been resheeted with weatherboard and windows replaced with multi-paned casements. Despite these alterations the original form can still be appreciated.

Significance *Level* *Xlocal* *city* *regional* *state* *national*

- For its historical associations with the early ferryman, W I Lawrence.
- As an example of relocation involving complete dismantling and re-erection.

Significance of Interior Not inspected

Associated Items

Comments

Historical information supplied by W I Lawrence's grandson, Mr T Lawrence.

Note: This report has been prepared on the basis of evidence examined by the investigator(s) and seeks to identify the most important heritage values of the item. The purpose of this report is to provide an initial evaluation. A conservation study by a qualified practitioner should be completed before any action is taken which may affect the significance of the item.

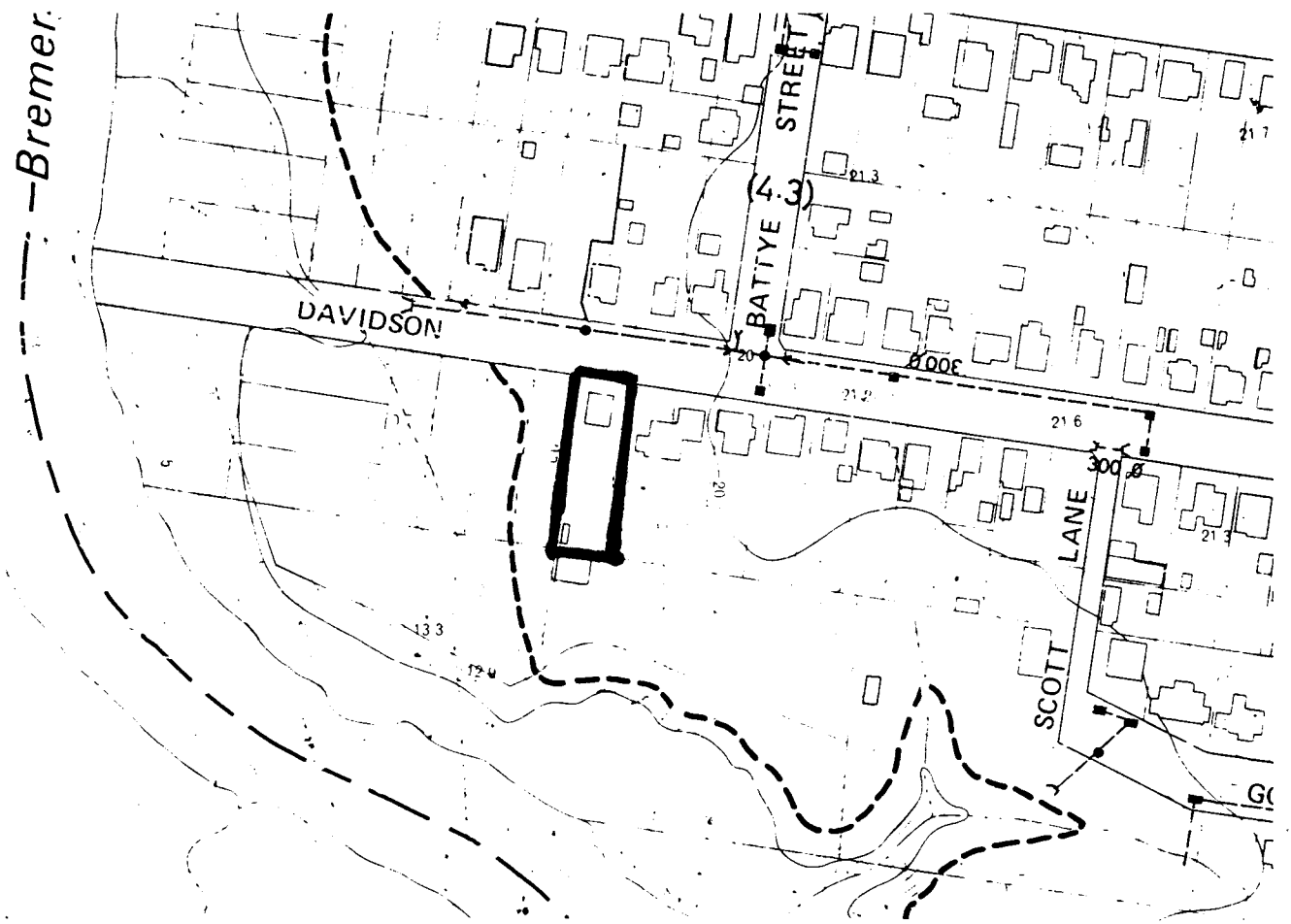

Source: Ipswich City Council. City of Ipswich topographic series. Amended to August 1990. Scale 1:2500. North at top of map. "@" = associated items.

Name 9 Grenville Street, Basin Pocket

Former/Other Name

Category House

Location 9 Grenville Street, Basin Pocket

RPD L159 RP24005 Par Ipswich

Local Authority Ipswich City Council

AMG Map Sheet SG 56-14, Ipswich **Grid** MQ7645

Present Tenure Mr F H K Radke & Mrs E Radke, 9 Grenville Street, Basin Pocket Qld 4305

Listing Boundary Whole allotment, plus adjoining footpath and including all established trees.

Other Listings

History

Although there have been additions of modern material to this house externally, Allen Cooper of the National Trust of Queensland, Ipswich branch, has advised that on close internal inspection this house retains its original form.

Description

This is a low set timber home which makes a dramatic enclosure to the view north up Howard Street, nestled behind a low neat hedge. It is a gable structure which is unusual for its development of the roof space that can presently be reached by a ladder fixed to a wall in the hallway. However, the 8 foot width of the central hallway provides ample space for the provision of an internal staircase if required. The present windows which admit light to the roof space replaced previous timber doors. The plan of the house is also much larger than usual, having 6 rooms as well as the wide central hallway. The house has been lined externally with chamferboards, however underneath this is the original exposed frame treatment which is still evident on the front verandah wall. The corrugated iron roof appears to be recently replaced, and that replacement appears to extend to the front and side verandah roof. However, the batten roof supports for the verandah appear quite old, as do the unpainted slatting to balustrade height and the venetian blinds. The house also has a rear detached kitchenhouse. Its exposed frame has been sheeted in with weatherboard, and possibly at the same time as this sheeting, the space between the house and the kitchenhouse was enclosed.

Significance **Level** *X*local city regional state national

- For its unusual form, with development of roof space.
- For its streetscape value as a striking closure of Howard Street.

Significance of Interior Not inspected

Associated Items**Comments**

Note: This report has been prepared on the basis of evidence examined by the investigator(s) and seeks to identify the most important heritage values of the item. The purpose of this report is to provide an initial evaluation. A conservation study by a qualified practitioner should be completed before any action is taken which may affect the significance of the item.

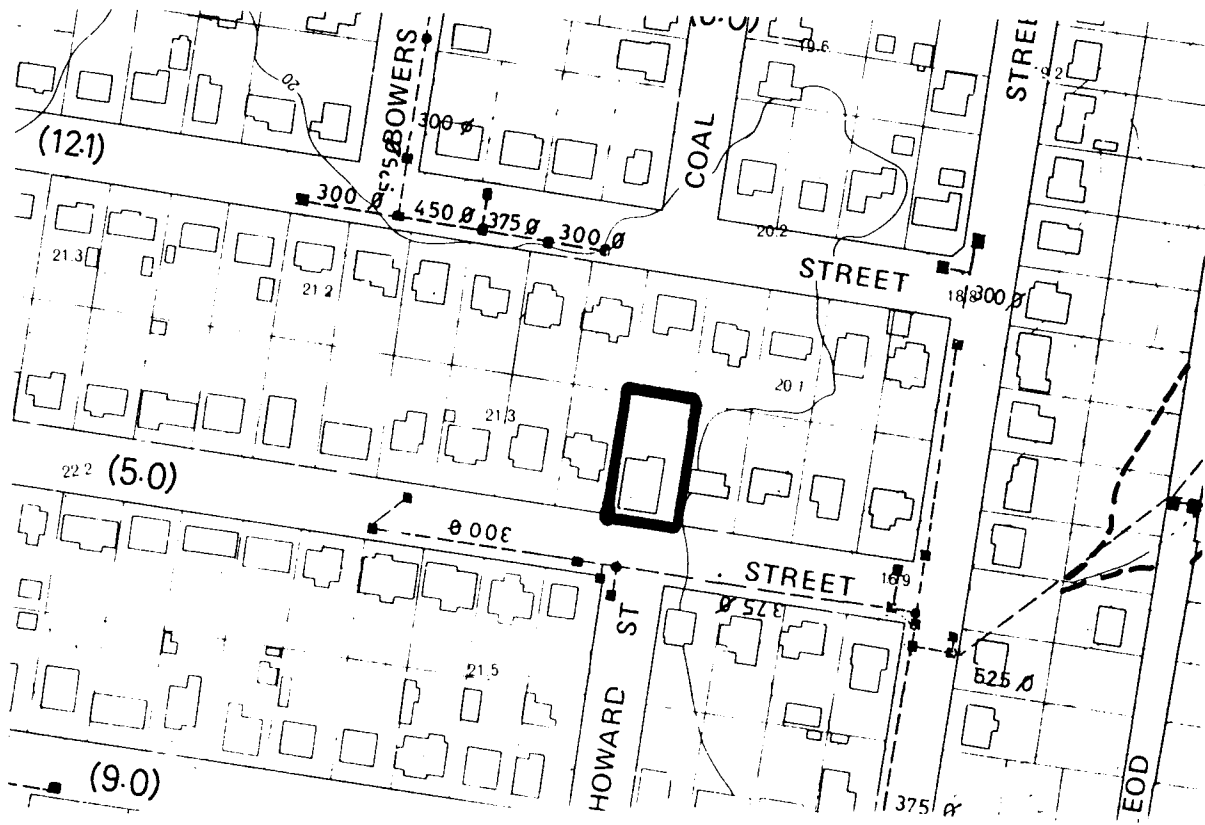

Source: Ipswich City Council. City of Ipswich topographic series. Amended to August 1990. Scale 1:2500. North at top of map. "@" = associated items.

Name H J Harper Band Hall

Former/Other Name East Ipswich Honour Hall

Category Hall

Location 64 Blackall Street, Basin Pocket

RPD L9 RP23973 Par Ipswich

Local Authority Ipswich City Council

AMG Map Sheet SG 56-14, Ipswich **Grid** MQ7645

Present Tenure Trustees of Ipswich Model Band, c/- Mrs C Bekendam, 41 Phyllis Street, Eastern Heights Qld 4305

Listing Boundary Whole allotment, plus adjoining footpath and including all established trees.

Other Listings

History

The hall was built around 1920 to honour those who had fought in World War 1, and was known as the East Ipswich Honour Hall. It was the scene of local social occasions, meetings of the Committee of the Trustees, and before and after World War II the place Tom Dalton taught dancing. In 1954 the Trustees sold the hall and used the money to erect memorial gates at the entrance of the park at 129 Chermiside Road, East Ipswich. Horace John Harper, long-time conductor of the Ipswich Model Band, was instrumental in acquiring the hall for the band, and it was named after him a few years afterwards. The Model Band had its beginnings in 1906 when a group, who had won a novelty award for a competition involving a band procession from Ipswich to the Showgrounds, decided to use their £5 winnings to form this band. The band continues to rehearse in the hall, and plays at local events. The band has traditionally been made up of local workers.

Description

This is a one storey weatherboard structure that is low set on timber stumps. It is gable ended with a moderately pitched corrugated iron roof. There is a smaller gabled front entry which has a lattice infill from sill height to the eaves of the corrugated iron roof. Windows are arranged in vertical groups of three hoppers, with those at the front and southern side covered by corrugated iron window hoods on timber stays and battened. The main front gable features exposed studs, whilst both the large and small entry gables have decoratively sheeted verges. There appears to be a rear skillion roofed weatherboard extension.

Significance **Level** *Xlocal* *city* *regional* *state* *national*

- For its early history as a World War 1 Honour Hall.
- For its association with the Ipswich Model Band.

Significance of Interior Not inspected

Associated Items**Comments**

Historical information supplied by H J Harper's son, Mr J Harper.

Note: This report has been prepared on the basis of evidence examined by the investigator(s) and seeks to identify the most important heritage values of the item. The purpose of this report is to provide an initial evaluation. A conservation study by a qualified practitioner should be completed before any action is taken which may affect the significance of the item.

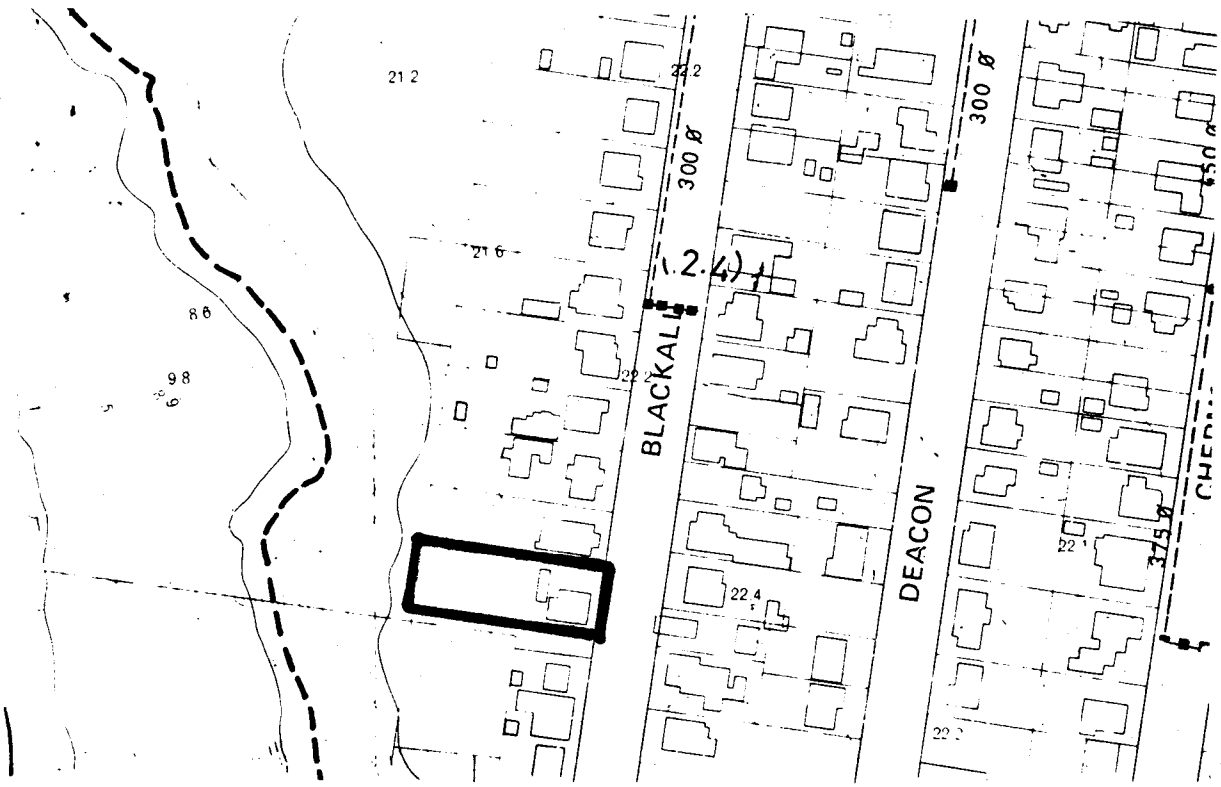

Source: Ipswich City Council. City of Ipswich topographic series. Amended to August 1990. Scale 1:2500. North at top of map. "@" = associated items.

Name "Villa Esrum"

Former/Other Name

Category House

Location 13 McGill Street, Basin Pocket

RPD L92 RP24005 Par Ipswich

Local Authority Ipswich City Council

AMG Map Sheet SG 56-14, Ipswich **Grid** MQ7645

Present Tenure Mrs H J Gavars, 13 McGill Street, Basin Pocket Qld 4305

Listing Boundary Whole allotment, plus adjoining footpath and including all established trees.

Other Listings**History**

The present owner was informed by a woman who had been born in the house, that the house was built in 1912 by a Russian builder. In early 1913, the first owners moved in. Apparently these first owners were farmers who owned the land around the house. As there were no schools in Basin Pocket at that time, the children in the house went to school in North Ipswich. The house is named 'Villa Esrum', but the current owner is unsure of its meaning.

Description

This is a square plan, one storey, weatherboard house moderately high set on timber stumps. It has a moderately pitched, corrugated iron pyramid roof. The stepped down, bull nosed verandah is also of corrugated iron and wraps around the front and the left sides. The verandah walls are lined internally with vertical boards and has exposed noggings. Sash windows overlook the verandah, whose detailing includes triple rail with dowel balusters and chamfered verandah posts. Between these posts are battened valances with decorative pendant. The side verandah facing Blackall Street also has roll down blinds behind the bays, and there has been a small weatherboard extension to the rear of this verandah. The house holds a prominent position at the corner of McGill and Blackall Streets, and its setting is enhanced by mature plantings at the McGill frontage, which includes palm trees.

Significance **Level** *X*local city regional state national

- As an example of traditional materials, form and detail.
- For its streetscape contribution at the intersection of McGill and Blackall Streets, including its plantings at the McGill Street frontage.

Significance of Interior Not inspected

Associated Items**Comments**

Note: This report has been prepared on the basis of evidence examined by the investigator(s) and seeks to identify the most important heritage values of the item. The purpose of this report is to provide an initial evaluation. A conservation study by a qualified practitioner should be completed before any action is taken which may affect the significance of the item.

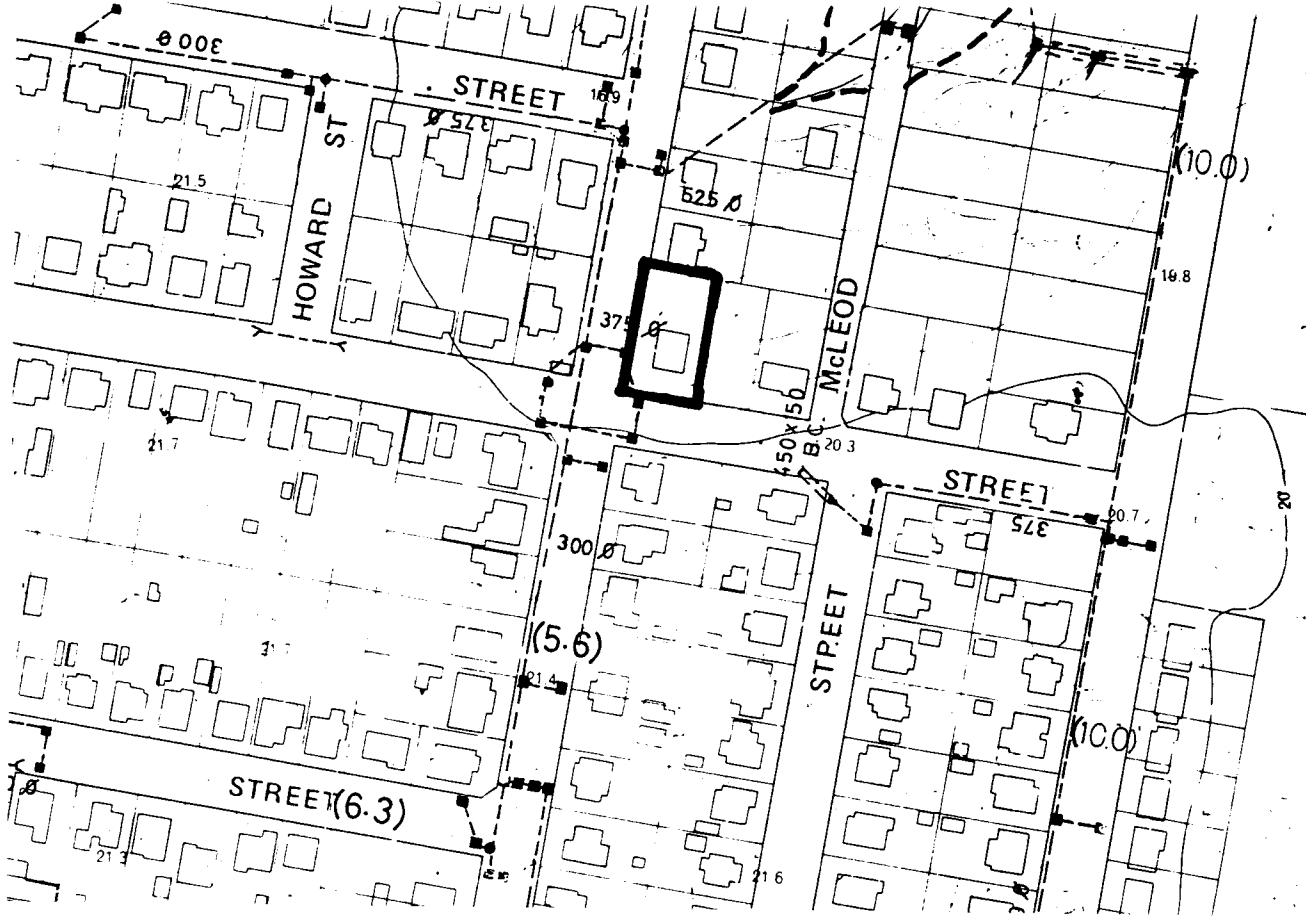

Source: Ipswich City Council. City of Ipswich topographic series. Amended to August 1990. Scale 1:2500. North at top of map. "@" = associated items.